

PROPOSED SUBDIVISION OF LOT 1 DP 626787, LOT 83 DP 650114, LOTS 27, 437 & DP755266. LANDSCAPE DEVELOPMENT APPLICATION DOCUMENTATION (DA) 285 - 305 PACIFIC HIGHWAY, LAKE MUNMORAH, NSW.



Sheet No.	Drawing Title	Revision	Date
LDD001	COVER SHEET	F	11/3/25
LDD002	SITE ANALYSIS PLAN	F	11/3/25
LDD003	SITE PLAN	F	11/3/25
LDD401	LANDSCAPE PLAN - PART A	F	11/3/25
LDD402	LANDSCAPE PLAN - PART B	F	11/3/25
LDD403	LANDSCAPE PLAN - PART C	F	11/3/25
LDD404	LANDSCAPE PLAN - PART D	F	11/3/25
LDD405	LANDSCAPE PLAN - PART E	F	11/3/25
LDD406	LANDSCAPE PLAN - PART F	F	11/3/25
LDD407	LANDSCAPE PLAN - PART G	F	11/3/25
LDD408	LANDSCAPE PLAN - PART H	F	11/3/25
LDD409	LANDSCAPE PLAN - PART I	F	11/3/25
LDD410	LANDSCAPE PLAN - PART J	F	11/3/25
LDD411	LANDSCAPE PLAN - PART K	F	11/3/25
LDD412	LANDSCAPE PLAN - PART L	F	11/3/25
LDD413	LANDSCAPE PLAN - PART M	F	11/3/25
LDD414	LANDSCAPE PLAN - PART N	F	11/3/25
LDD415	LANDSCAPE PLAN - PART O	F	11/3/25
LDD416	LANDSCAPE PLAN - PART P	F	11/3/25
LDD417	LANDSCAPE PLAN - PART Q	F	11/3/25
LDD418	LANDSCAPE PLAN - PART R	F	11/3/25
LDD419	LANDSCAPE PLAN - PART S	F	11/3/25
LDD420	LANDSCAPE PLAN - PART T	F	11/3/25
LDD701	THEMING PLAN	F	11/3/25
LDD702	THEMING PLAN	F	11/3/25

LOCALITY PLAN
Scale: 1:10000
Source: Nearmap, 2023
0 200 400 600m



Studio 1, 88 Fern Street
PO Box 111
Islington NSW 2296
Phone (02) 4965 3500
admin@moirla.com.au
www.moirla.com.au

ARCHITECT:

ENGINEER:
Barker Ryan Stewart

CLIENT:
Alda Properties Pty Ltd

NOTE: DRAWING PURPOSES FOR APPROVAL ONLY. NOT FOR CONSTRUCTION.

No:	DATE:	REVISION:
A	28/8/23	FOR APPROVAL
B	21/11/23	FOR APPROVAL
C	1/5/24	FOR APPROVAL
D	21/5/24	FOR APPROVAL
E	11/3/25	FOR APPROVAL
F	11/3/25	FOR APPROVAL

BY:	PROJECT:
CN	Proposed Subdivision
RD	Darkinjung & Awabakal Country
CL	285 - 305 Pacific Highway, Lake Munmorah NSW
CL	Status: FOR APPROVAL
MG	
MG	

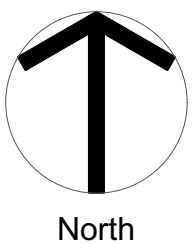

COVER SHEET

SCALE:	AS SHOWN	Project No.	2353
ORIGINAL DRAWING AT A1.		Drawing No.	Rev
Drawn By: RD		LDD001	F
Checked By: YZ	Approved By: DM		



- LEGEND**
- Stage boundary
 - Lot boundary
 - (B) Bus shelter
 - (C) Community hall
 - (SC) School
 - (CH) Church
 - (BO) Bowling club
 - (T) Tennis club
 - Major Road
 - Minor Road
 - Proposed entrance to project site
 - Overhead power lines



Studio 1, 88 Fern Street
PO Box 111
Islington NSW 2296
Phone (02) 4965 3500
admin@moirla.com.au
www.moirla.com.au

ARCHITECT:

ENGINEER:
Barker Ryan Stewart

CLIENT:
Alda Properties Pty Ltd

NOTE: DRAWING PURPOSES FOR APPROVAL ONLY. NOT FOR CONSTRUCTION.

No:	DATE:	REVISION:
A	28/8/23	FOR APPROVAL
B	21/11/23	FOR APPROVAL
C	1/5/24	FOR APPROVAL
D	21/5/24	FOR APPROVAL
E	11/3/25	FOR APPROVAL
F	11/3/25	FOR APPROVAL

BY:
CN
RD
CL
CL
MG
MG

PROJECT:
Proposed Subdivision
Darkinjung & Awabakal Country
285 - 305 Pacific Highway, Lake Munmorah NSW
Status: FOR APPROVAL

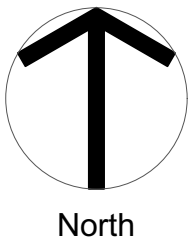

SITE ANALYSIS PLAN

SCALE: 1:5000
ORIGINAL DRAWING AT A1.
Drawn By: RD
Checked By: YZ

Project No. 2353
Drawing No. LDD002
Rev F

LEGEND

- Stage boundary
- Lot boundary
- P1 Concrete footpath - by others
- P2 Driveway - by others
- Proposed lots
- Drainage reserve
- Road - by others
- T Turf
- Mulch Softfall
- Rubber Softfall
- Sandstone Log Wall and Seating
- Scour Protection to Engineers Detail
- Lapped and Capped Acoustic Wall - 1.8m high
- C2 Land Boundary

MASS PLANTING

- MP1 Mass Planting Type 1 - Refer Plant Schedule
- MP2 Mass Planting Type 2 - Refer Plant Schedule
- MP3 Mass Planting Type 3 - Refer Plant Schedule
- MP4 Mass Planting Type 4 - Refer Plant Schedule
- MP5 Mass Planting Type 5 - Refer Plant Schedule

STREET TREES

- Corymbia maculata Spotted Gum
- Corymbia eximia 'Nana' Dwarf Yellow Bloodwood
- Lophostemon confertus Brush Box
- Magnolia grandiflora Bull Bay Magnolia
- Melaleuca quinquenervia Broad-leaved Paperbark
- Tristaniopsis laurina 'Luscious' Water Gum
- Ulmus parvifolia 'Todd' Todd Chinese Elm
- Waterhousea floribunda Weeping Lilly Pilly

TREES/ SCREEN SHRUBS

- Acer negundo 'Sensation' Manitob Maple

REFER TO LDD 402 - LANDSCAPE PLAN - PART B

REFER TO LDD 404 - LANDSCAPE PLAN - PART D

0 5 10 15 20m



Studio 1, 88 Fern Street
PO Box 111
Islington NSW 2296
Phone (02) 4965 3500
admin@moirla.com.au
www.moirla.com.au

ARCHITECT:

ENGINEER:
Barker Ryan Stewart

CLIENT:

Alda Properties Pty Ltd

NOTE: DRAWING PURPOSES FOR APPROVAL ONLY. NOT FOR CONSTRUCTION.

No:	DATE:	REVISION:
A	28/8/23	FOR APPROVAL
B	21/11/23	FOR APPROVAL
C	1/5/24	FOR APPROVAL
D	21/5/24	FOR APPROVAL
E	11/3/25	FOR APPROVAL
F	11/3/25	FOR APPROVAL

BY:
CN
RD
CL
CL
MG
MG

PROJECT:

Proposed Subdivision
Darkinjung & Awabakal Country
285 - 305 Pacific Highway, Lake Munmorah NSW
Status: FOR APPROVAL

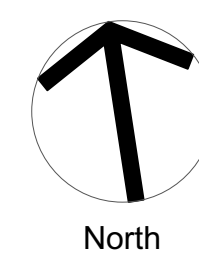

LANDSCAPE PLAN - PART A

SCALE: 1:250

ORIGINAL DRAWING AT A1.
Drawn By: RD
Checked By: YZ

Project No.

Drawing No. 2353
Rev F
LDD401

REFER TO LDD 401 - LANDSCAPE PLAN - PART A

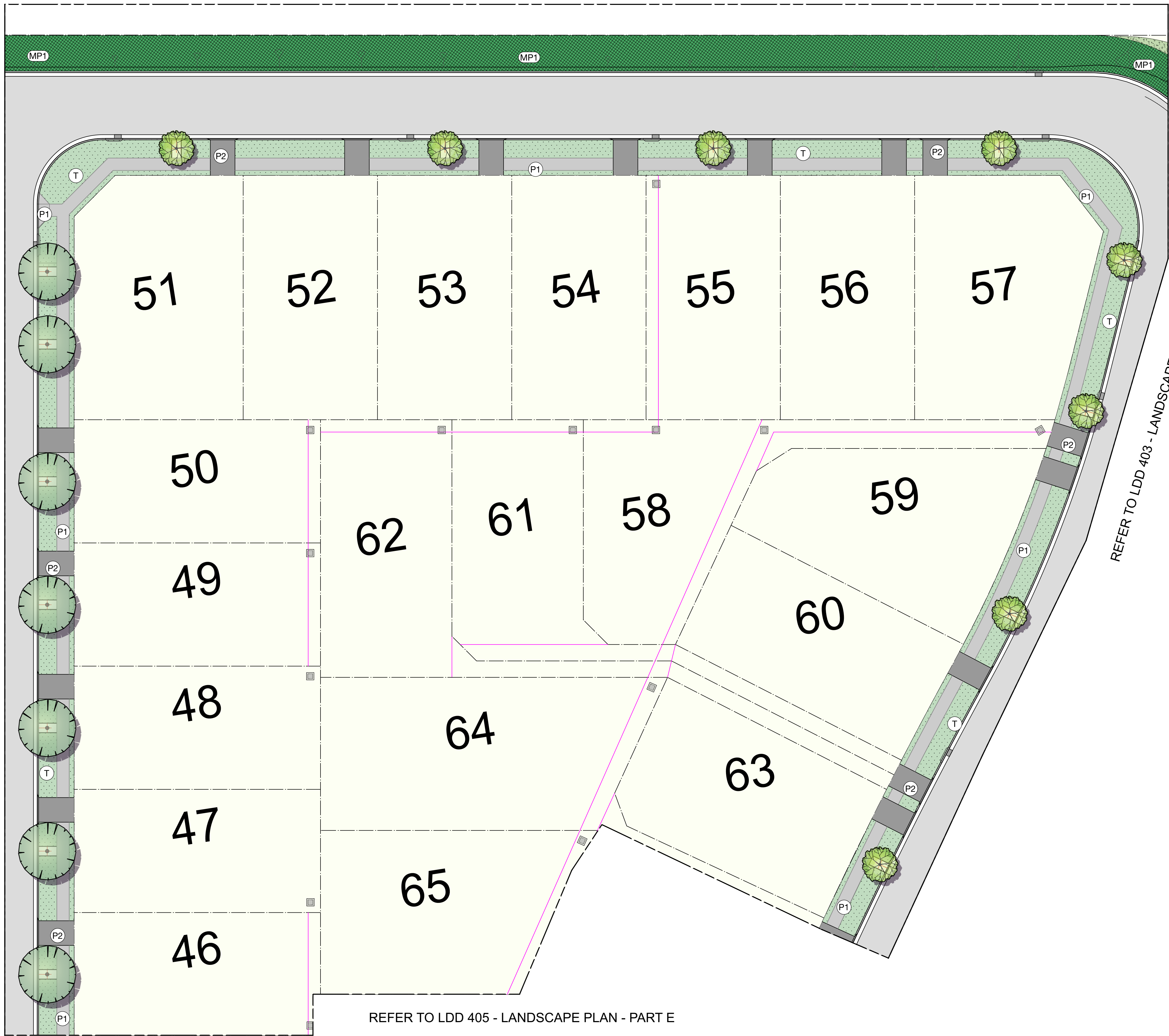

REFER TO LDD 405 - LANDSCAPE PLAN - PART E

REFER TO LDD 403 - LANDSCAPE PLAN - PART C

LEGEND

- Stage boundary
- Lot boundary
- Concrete footpath - by others (P1)
- Driveway - by others (P2)
- Proposed lots
- Drainage reserve
- Road - by others
- Turf (T)
- Mulch Softfall
- Rubber Softfall
- Sandstone Log Wall and Seating
- Scour Protection to Engineers Detail
- Lapped and Capped Acoustic Wall - 1.8m high
- C2 Land Boundary

MASS PLANTING

- Mass Planting Type 1 - Refer Plant Schedule (MP1)
- Mass Planting Type 2 - Refer Plant Schedule (MP2)
- Mass Planting Type 3 - Refer Plant Schedule (MP3)
- Mass Planting Type 4 - Refer Plant Schedule (MP4)
- Mass Planting Type 5 - Refer Plant Schedule (MP5)

STREET TREES

- Corymbia maculata* Spotted Gum
- Corymbia eximia* 'Nana' Dwarf Yellow Bloodwood
- Lophostemon confertus* Brush Box
- Magnolia grandiflora* Bull Bay Magnolia
- Melaleuca quinquenervia* Broad-leaved Paperbark
- Tristania laurina* 'Luscious' Water Gum
- Ulmus parvifolia* 'Todd' Todd Chinese Elm
- Waterhousea floribunda* Weeping Lilly Pilly

TREES/ SCREEN SHRUBS

- Acer negundo* 'Sensation' Manitob Maple

0 5 10 15 20m



Studio 1, 88 Fern Street
PO Box 111
Islington NSW 2296
Phone (02) 4965 3500
admin@moirla.com.au
www.moirla.com.au

ARCHITECT:

ENGINEER:
Barker Ryan Stewart

CLIENT:

Alda Properties Pty Ltd

NOTE: DRAWING PURPOSES FOR APPROVAL ONLY. NOT FOR CONSTRUCTION.

No: DATE: REVISION:
A 28/8/23 FOR APPROVAL
B 21/11/23 FOR APPROVAL
C 1/5/24 FOR APPROVAL
D 21/5/24 FOR APPROVAL
E 11/3/25 FOR APPROVAL
F 11/3/25 FOR APPROVAL

BY:
CN
RD
CL
CL
MG
MG

PROJECT:

Proposed Subdivision
Darkinjung & Awabakal Country
285 - 305 Pacific Highway, Lake Munmorah NSW
Status: FOR APPROVAL

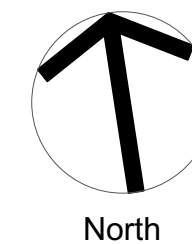

LANDSCAPE PLAN - PART B

SCALE: 1:250

ORIGINAL DRAWING AT A1.
Drawn By: RD
Checked By: YZ

Project No.

Drawing No. 2353
Rev. F
LDD402

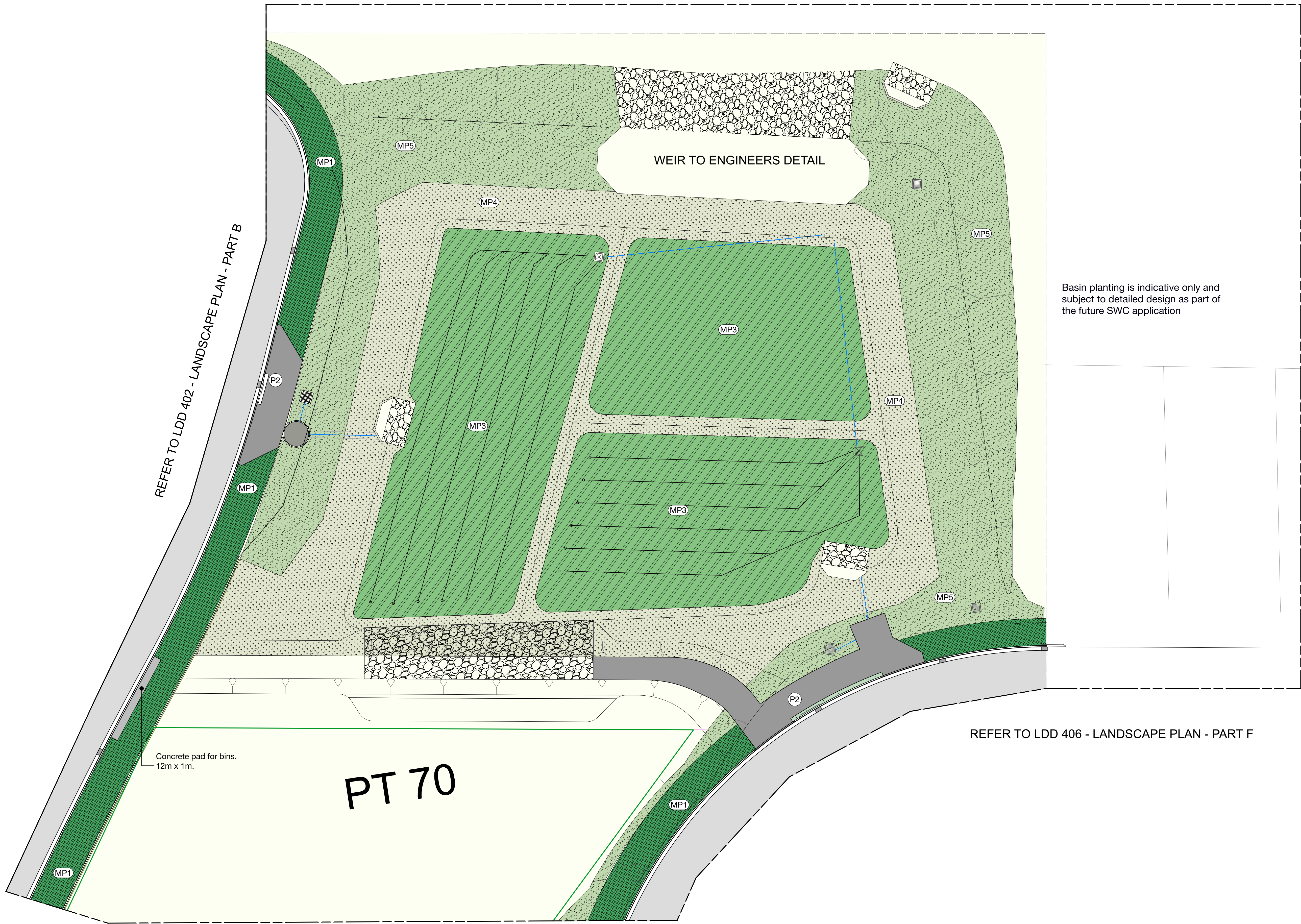

LEGEND

- Stage boundary
- Lot boundary
- Concrete footpath - by others
- Driveway - by others
- Proposed lots
- Drainage reserve
- Road - by others
- Turf
- Mulch Softfall
- Rubber Softfall
- Sandstone Log Wall and Seating
- Scour Protection to Engineers Detail
- Lapped and Capped Acoustic Wall - 1.8m high
- C2 Land Boundary

MASS PLANTING

- Mass Planting Type 1 - Refer Plant Schedule
- Mass Planting Type 2 - Refer Plant Schedule
- Mass Planting Type 3 - Refer Plant Schedule
- Mass Planting Type 4 - Refer Plant Schedule
- Mass Planting Type 5 - Refer Plant Schedule

STREET TREES

- Corymbia maculata* Spotted Gum
- Corymbia eximia* 'Nana' Dwarf Yellow Bloodwood
- Lophostemon confertus* Brush Box
- Magnolia grandiflora* Bull Bay Magnolia
- Melaleuca quinquenervia* Broad-leaved Paperbark
- Tristaniopsis laurina* 'Luscious' Water Gum
- Ulmus parvifolia* 'Todd' Todd Chinese Elm
- Waterhousea floribunda* Weeping Lilly Pilly

TREES/ SCREEN SHRUBS

- Acer negundo* 'Sensation' Manitob Maple

REFER TO LDD 405 - LANDSCAPE PLAN - PART E

REFER TO LDD 406 - LANDSCAPE PLAN - PART F

0 5 10 15 20m



Studio 1, 88 Fern Street
PO Box 111
Islington NSW 2296
Phone (02) 4965 3500
admin@moirla.com.au
www.moirla.com.au

ARCHITECT:

ENGINEER:
Barker Ryan Stewart

CLIENT:

Alda Properties Pty Ltd

NOTE: DRAWING PURPOSES FOR APPROVAL ONLY. NOT FOR CONSTRUCTION.

No:	DATE:	REVISION:
A	28/8/23	FOR APPROVAL
B	21/11/23	FOR APPROVAL
C	1/5/24	FOR APPROVAL
D	21/5/24	FOR APPROVAL
E	11/3/25	FOR APPROVAL
F	11/3/25	FOR APPROVAL

BY:
CN
RD
CL
CL
MG
MG

PROJECT:

Proposed Subdivision
Darkinjung & Awabakal Country
285 - 305 Pacific Highway, Lake Munmorah NSW
Status: FOR APPROVAL

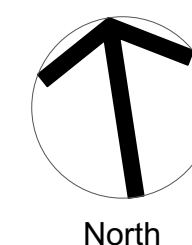

LANDSCAPE PLAN - PART C

SCALE: 1:250

ORIGINAL DRAWING AT A1.
Drawn By: RD
Checked By: YZ

Project No.

2353

Drawing No.

LDD403

Rev

F

REFER TO LDD 401 - LANDSCAPE PLAN - PART A

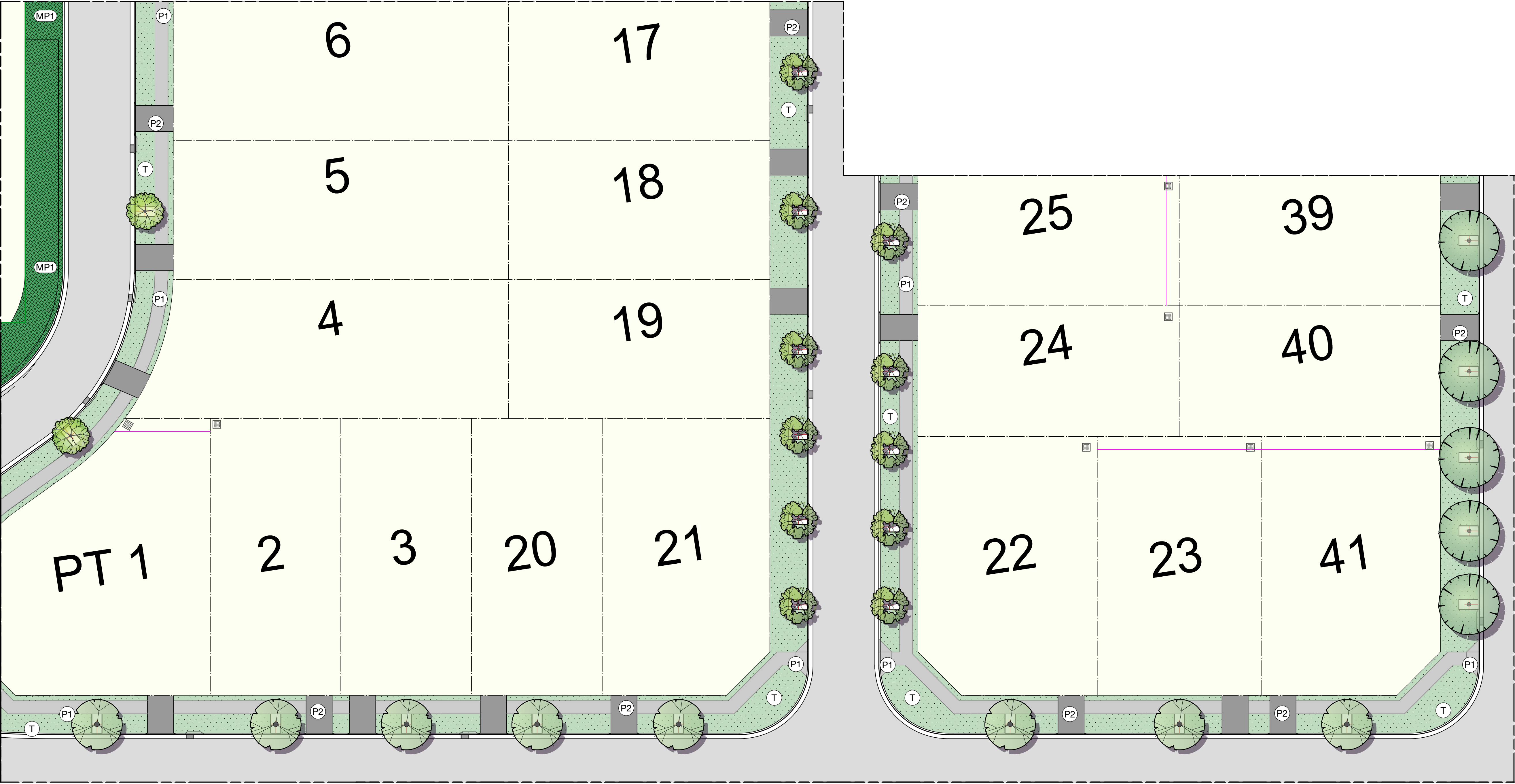

REFER TO LDD 408 - LANDSCAPE PLAN - PART H

LEGEND

- Stage boundary
- Lot boundary
- Concrete footpath - by others (P1)
- Driveway - by others (P2)
- Proposed lots
- Drainage reserve
- Road - by others
- Turf (T)
- Mulch Softfall
- Rubber Softfall
- Sandstone Log Wall and Seating
- Scour Protection to Engineers Detail
- Lapped and Capped Acoustic Wall - 1.8m high
- C2 Land Boundary

MASS PLANTING

- Mass Planting Type 1 - Refer Plant Schedule (MP1)
- Mass Planting Type 2 - Refer Plant Schedule (MP2)
- Mass Planting Type 3 - Refer Plant Schedule (MP3)
- Mass Planting Type 4 - Refer Plant Schedule (MP4)
- Mass Planting Type 5 - Refer Plant Schedule (MP5)

STREET TREES

- Corymbia maculata* Spotted Gum
- Corymbia eximia* 'Nana' Dwarf Yellow Bloodwood
- Lophostemon confertus* Brush Box
- Magnolia grandiflora* Bull Bay Magnolia
- Melaleuca quinquenervia* Broad-leaved Paperbark
- Tristaniopsis laurina* 'Luscious' Water Gum
- Ulmus parvifolia* 'Todd' Todd Chinese Elm
- Waterhousea floribunda* Weeping Lilly Pilly

TREES/ SCREEN SHRUBS

- Acer negundo* 'Sensation' Manitob Maple

REFER TO LDD 405 - LANDSCAPE PLAN - PART E

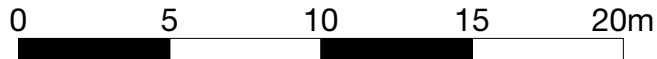

Studio 1, 88 Fern Street
PO Box 111
Islington NSW 2296
Phone (02) 4965 3500
admin@moirla.com.au
www.moirla.com.au

ARCHITECT:

ENGINEER:

Barker Ryan Stewart

CLIENT:

Alda Properties Pty Ltd

NOTE: DRAWING PURPOSES FOR APPROVAL ONLY. NOT FOR CONSTRUCTION.

No:	DATE:	REVISION:
A	28/8/23	FOR APPROVAL
B	21/11/23	FOR APPROVAL
C	1/5/24	FOR APPROVAL
D	21/5/24	FOR APPROVAL
E	11/3/25	FOR APPROVAL
F	11/3/25	FOR APPROVAL

BY:

CN
RD
CL
CL
MG
MG

PROJECT:

Proposed Subdivision
Darkinjung & Awabakal Country
285 - 305 Pacific Highway, Lake Munmorah NSW
Status: FOR APPROVAL

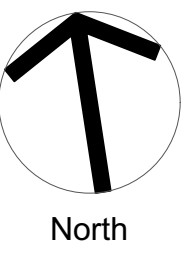

LANDSCAPE PLAN - PART D

SCALE: 1:250

ORIGINAL DRAWING AT A1.
Drawn By: RD
Checked By: YZ

Project No.

Drawing No. 2353
Rev F

LEGEND

- Stage boundary
- Lot boundary
- Concrete footpath - by others (P1)
- Driveway - by others (P2)
- Proposed lots
- Drainage reserve
- Road - by others
- Turf (T)
- Mulch Softfall
- Rubber Softfall
- Sandstone Log Wall and Seating
- Scour Protection to Engineers Detail
- Lapped and Capped Acoustic Wall - 1.8m high
- C2 Land Boundary

MASS PLANTING

- Mass Planting Type 1 - Refer Plant Schedule (MP1)
- Mass Planting Type 2 - Refer Plant Schedule (MP2)
- Mass Planting Type 3 - Refer Plant Schedule (MP3)
- Mass Planting Type 4 - Refer Plant Schedule (MP4)
- Mass Planting Type 5 - Refer Plant Schedule (MP5)

STREET TREES

- Corymbia maculata* Spotted Gum
- Corymbia eximia* 'Nana' Dwarf Yellow Bloodwood
- Lophostemon confertus* Brush Box
- Magnolia grandiflora* Bull Bay Magnolia
- Melaleuca quinquenervia* Broad-leaved Paperbark
- Tristaniopsis laurina* 'Luscious' Water Gum
- Ulmus parvifolia* 'Todd' Todd Chinese Elm
- Waterhousea floribunda* Weeping Lilly Pilly

TREES/ SCREEN SHRUBS

- Acer negundo* 'Sensation' Manitob Maple

REFER TO LDD 406 - LANDSCAPE PLAN - PART F

REFER TO LDD 403 - LANDSCAPE PLAN - PART C

REFER TO LDD 402 - LANDSCAPE PLAN - PART B

REFER TO LDD 404 - LANDSCAPE PLAN - PART D

REFER TO LDD 408 - LANDSCAPE PLAN - PART H

REFER TO LDD 409 - LANDSCAPE PLAN - PART C

0 5 10 15 20m



Studio 1, 88 Fern Street
PO Box 111
Islington NSW 2296
Phone (02) 4965 3500
admin@moirla.com.au
www.moirla.com.au

ARCHITECT:

ENGINEER:

Barker Ryan Stewart

CLIENT:

Alda Properties Pty Ltd

NOTE: DRAWING PURPOSES FOR APPROVAL ONLY. NOT FOR CONSTRUCTION.

No:	DATE:	REVISION:
A	28/8/23	FOR APPROVAL
B	21/11/23	FOR APPROVAL
C	1/5/24	FOR APPROVAL
D	21/5/24	FOR APPROVAL
E	11/3/25	FOR APPROVAL
F	11/3/25	FOR APPROVAL

BY:

CN
RD
CL
CL
MG
MG

PROJECT:

Proposed Subdivision

Darkinjung & Awabakal Country

285 - 305 Pacific Highway, Lake Munmorah NSW

Status: FOR APPROVAL

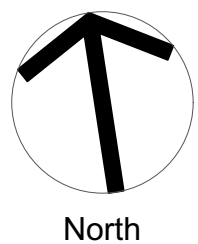

LANDSCAPE PLAN - PART E

SCALE: 1:250

ORIGINAL DRAWING AT A1.

Drawn By: RD

Checked By: YZ

Project No.

2353

Drawing No.

LDD405

Rev F

REFER TO LDD 403 - LANDSCAPE PLAN - PART C

REFER TO LDD 405 - LANDSCAPE PLAN - PART C



REFER TO LDD 410 - LANDSCAPE PLAN - PART J

LEGEND

- Stage boundary
- Lot boundary
- Concrete footpath - by others (P1)
- Driveway - by others (P2)
- Proposed lots
- Drainage reserve
- Road - by others
- Turf (T)
- Mulch Softfall
- Rubber Softfall
- Sandstone Log Wall and Seating
- Scour Protection to Engineers Detail
- Lapped and Capped Acoustic Wall - 1.8m high
- C2 Land Boundary

MASS PLANTING

- Mass Planting Type 1 - Refer Plant Schedule (MP1)
- Mass Planting Type 2 - Refer Plant Schedule (MP2)
- Mass Planting Type 3 - Refer Plant Schedule (MP3)
- Mass Planting Type 4 - Refer Plant Schedule (MP4)
- Mass Planting Type 5 - Refer Plant Schedule (MP5)

STREET TREES

- Corymbia maculata* Spotted Gum
- Corymbia eximia* 'Nana' Dwarf Yellow Bloodwood
- Lophostemon confertus* Brush Box
- Magnolia grandiflora* Bull Bay Magnolia
- Melaleuca quinquenervia* Broad-leaved Paperbark
- Tristaniopsis laurina* 'Luscious' Water Gum
- Ulmus parvifolia* 'Todd' Todd Chinese Elm
- Waterhousea floribunda* Weeping Lilly Pilly

TREES/ SCREEN SHRUBS

- Acer negundo* 'Sensation' Manitob Maple

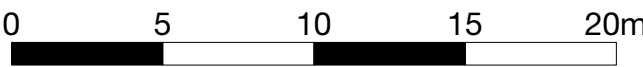

Studio 1, 88 Fern Street
PO Box 111
Islington NSW 2296
Phone (02) 4965 3500
admin@moirla.com.au
www.moirla.com.au

ARCHITECT:

ENGINEER:

Barker Ryan Stewart

CLIENT:

Alda Properties Pty Ltd

NOTE: DRAWING PURPOSES FOR APPROVAL ONLY. NOT FOR CONSTRUCTION.

No: A DATE: 28/8/23 REVISION: FOR APPROVAL
B DATE: 21/11/23 REVISION: FOR APPROVAL
C DATE: 1/5/24 REVISION: FOR APPROVAL
D DATE: 21/5/24 REVISION: FOR APPROVAL
E DATE: 11/3/25 REVISION: FOR APPROVAL
F DATE: 11/3/25 REVISION: FOR APPROVAL

BY: CN
RD
CL
CL
MG
MG

PROJECT:

Proposed Subdivision

Darkinjung & Awabakal Country

285 - 305 Pacific Highway, Lake Munmorah NSW

Status: FOR APPROVAL

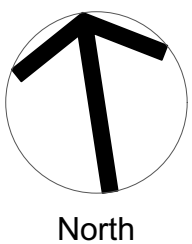

LANDSCAPE PLAN - PART F

SCALE: 1:250

ORIGINAL DRAWING AT A1.

Drawn By: RD

Checked By: YZ

Project No.

2353

Drawing No.

LDD406

Rev F



- LEGEND
- Stage boundary
 - Lot boundary
 - Concrete footpath - by others (P1)
 - Driveway - by others (P2)
 - Proposed lots
 - Drainage reserve
 - Road - by others
 - Turf (T)
 - Mulch Softfall
 - Rubber Softfall
 - Sandstone Log Wall and Seating
 - Scour Protection to Engineers Detail
 - Lapped and Capped Acoustic Wall - 1.8m high
 - C2 Land Boundary

- MASS PLANTING
- Mass Planting Type 1 - Refer Plant Schedule (MP1)
 - Mass Planting Type 2 - Refer Plant Schedule (MP2)
 - Mass Planting Type 3 - Refer Plant Schedule (MP3)
 - Mass Planting Type 4 - Refer Plant Schedule (MP4)
 - Mass Planting Type 5 - Refer Plant Schedule (MP5)

- STREET TREES
- Corymbia maculata* Spotted Gum
 - Corymbia eximia* 'Nana' Dwarf Yellow Bloodwood
 - Lophostemon confertus* Brush Box
 - Magnolia grandiflora* Bull Bay Magnolia
 - Melaleuca quinquenervia* Broad-leaved Paperbark
 - Tristaniopsis laurina* 'Luscious' Water Gum
 - Ulmus parvifolia* 'Todd' Todd Chinese Elm
 - Waterhousea floribunda* Weeping Lilly Pilly
- TREES/ SCREEN SHRUBS
- Acer negundo* 'Sensation' Manitob Maple



Studio 1, 88 Fern Street
PO Box 111
Islington NSW 2296
Phone (02) 4965 3500
admin@moirla.com.au
www.moirla.com.au

ARCHITECT:
ENGINEER:
Barker Ryan Stewart

CLIENT:
Alda Properties Pty Ltd

NOTE: DRAWING PURPOSES FOR APPROVAL ONLY. NOT FOR CONSTRUCTION.

No: DATE: REVISION:
A 28/8/23 FOR APPROVAL
B 21/11/23 FOR APPROVAL
C 1/5/24 FOR APPROVAL
D 21/5/24 FOR APPROVAL
E 11/3/25 FOR APPROVAL
F 11/3/25 FOR APPROVAL

BY: PROJECT:
CN Proposed Subdivision
RD Darkinjung & Awabakal Country
CL 285 - 305 Pacific Highway, Lake Munmorah NSW
CL
MG
Status: FOR APPROVAL

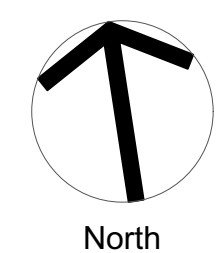

LANDSCAPE PLAN - PART G

SCALE: 1:250 Project No. 2353

ORIGINAL DRAWING AT A1. Drawing No. Rev
Drawn By: RD Checked By: YZ Approved By: DM LDD407 F

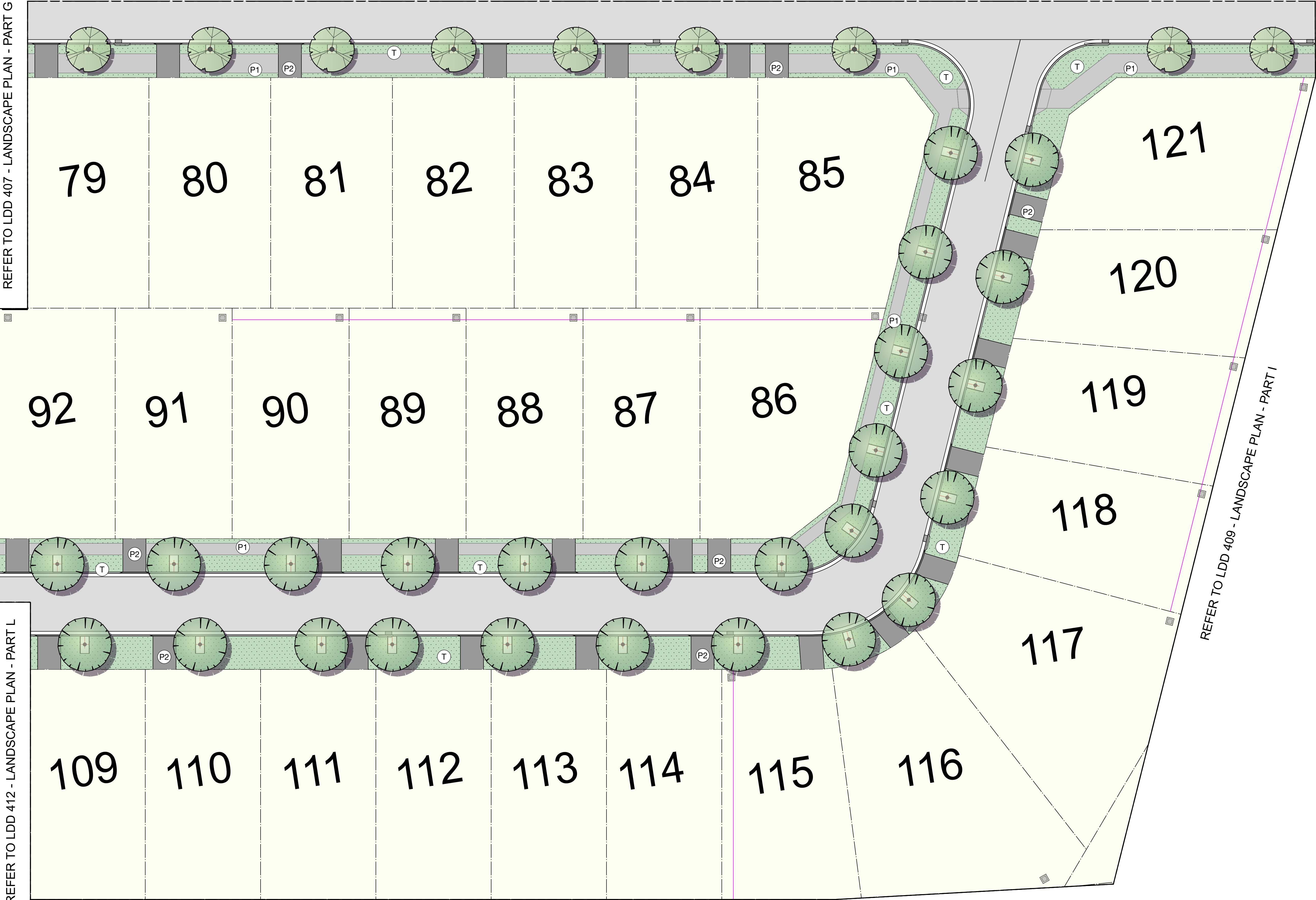

LEGEND

- Stage boundary
- Lot boundary
- P1 Concrete footpath - by others
- P2 Driveway - by others
- Proposed lots
- Drainage reserve
- Road - by others
- Turf
- Mulch Softfall
- Rubber Softfall
- Sandstone Log Wall and Seating
- Scour Protection to Engineers Detail
- Lapped and Capped Acoustic Wall - 1.8m high
- C2 Land Boundary

MASS PLANTING

- MP1 Mass Planting Type 1 - Refer Plant Schedule
- MP2 Mass Planting Type 2 - Refer Plant Schedule
- MP3 Mass Planting Type 3 - Refer Plant Schedule
- MP4 Mass Planting Type 4 - Refer Plant Schedule
- MP5 Mass Planting Type 5 - Refer Plant Schedule

STREET TREES

- Corymbia maculata Spotted Gum
- Corymbia eximia 'Nana' Dwarf Yellow Bloodwood
- Lophostemon confertus Brush Box
- Magnolia grandiflora Bull Bay Magnolia
- Melaleuca quinquenervia Broad-leaved Paperbark
- Tristanopsis laurina 'Luscious' Water Gum
- Ulmus parvifolia 'Todd' Todd Chinese Elm
- Waterhousea floribunda Weeping Lilly Pilly

TREES/ SCREEN SHRUBS

- Acer negundo 'Sensation' Manitob Maple

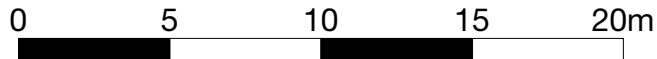

Studio 1, 88 Fern Street
PO Box 111
Islington NSW 2296
Phone (02) 4965 3500
admin@moirla.com.au
www.moirla.com.au

ARCHITECT:

ENGINEER:

Barker Ryan Stewart

CLIENT:

Alda Properties Pty Ltd

NOTE: DRAWING PURPOSES FOR APPROVAL ONLY. NOT FOR CONSTRUCTION.

No:	DATE:	REVISION:
A	28/8/23	FOR APPROVAL
B	21/11/23	FOR APPROVAL
C	1/5/24	FOR APPROVAL
D	21/5/24	FOR APPROVAL
E	11/3/25	FOR APPROVAL
F	11/3/25	FOR APPROVAL

BY:

CN
RD
CL
CL
MG
MG

PROJECT:

Proposed Subdivision
Darkinjung & Awabakal Country
285 - 305 Pacific Highway, Lake Munmorah NSW
Status: FOR APPROVAL

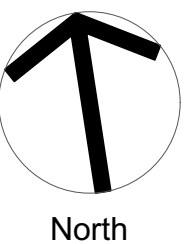

LANDSCAPE PLAN - PART H

SCALE: 1:250

ORIGINAL DRAWING AT A1.
Drawn By: RD
Checked By: YZ

Project No.

Drawing No. 2353
Rev F
LDD408

REFER TO LDD 405 - LANDSCAPE PLAN - PART E

REFER TO LDD 408 - LANDSCAPE PLAN - PART H

REFER TO LDD 410 - LANDSCAPE PLAN - PART J

REFER TO LDD 415 - LANDSCAPE PLAN - PART O

REFER TO LDD 414 - LANDSCAPE PLAN - PART N

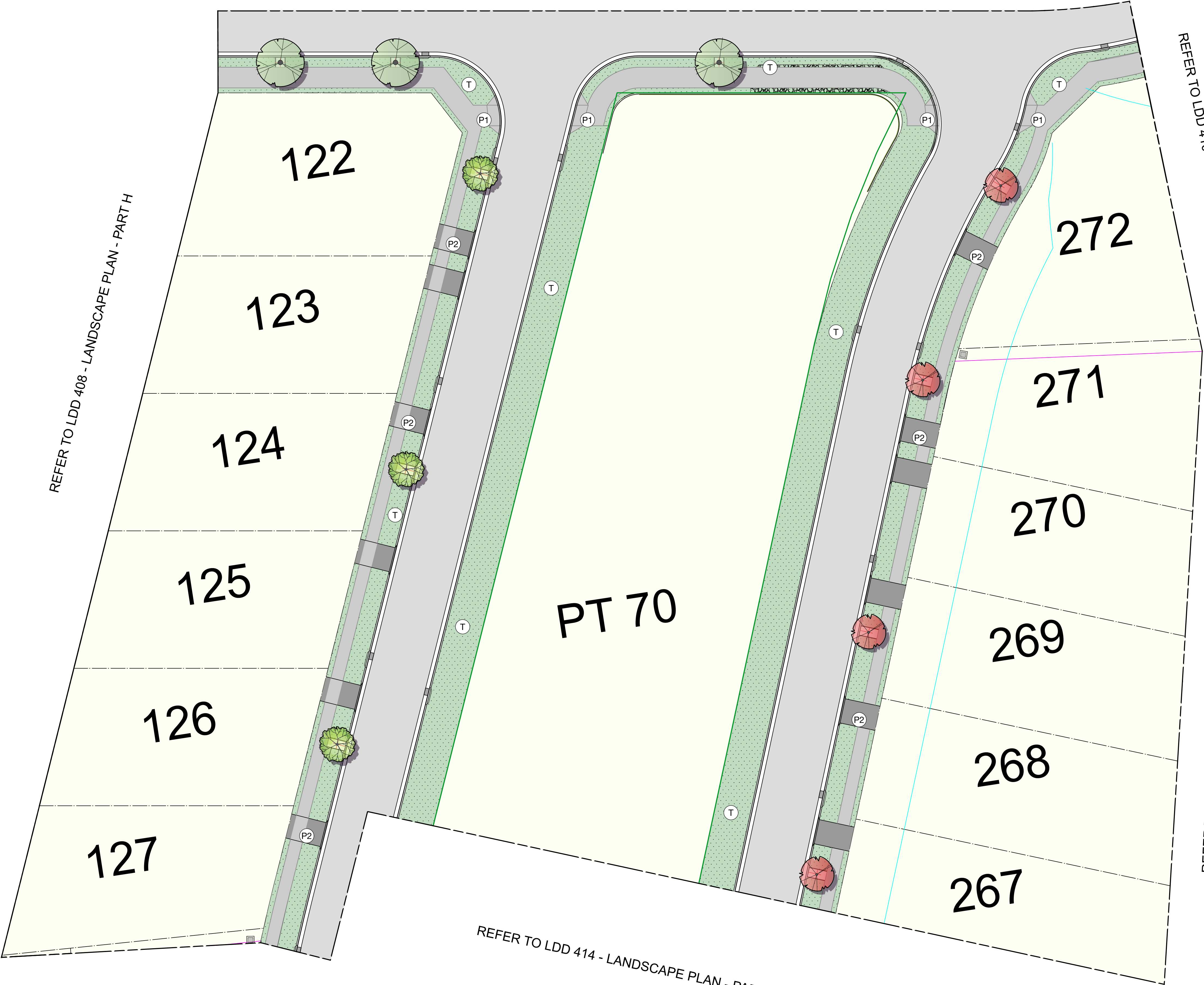

LEGEND

- Stage boundary
- Lot boundary
- Concrete footpath - by others (P1)
- Driveway - by others (P2)
- Proposed lots
- Drainage reserve
- Road - by others
- Turf (T)
- Mulch Softfall
- Rubber Softfall
- Sandstone Log Wall and Seating
- Scour Protection to Engineers Detail
- Lapped and Capped Acoustic Wall - 1.8m high
- C2 Land Boundary

MASS PLANTING

- Mass Planting Type 1 - Refer Plant Schedule (MP1)
- Mass Planting Type 2 - Refer Plant Schedule (MP2)
- Mass Planting Type 3 - Refer Plant Schedule (MP3)
- Mass Planting Type 4 - Refer Plant Schedule (MP4)
- Mass Planting Type 5 - Refer Plant Schedule (MP5)

STREET TREES

- Corymbia maculata* Spotted Gum
- Corymbia eximia* 'Nana' Dwarf Yellow Bloodwood
- Lophostemon confertus* Brush Box
- Magnolia grandiflora* Bull Bay Magnolia
- Melaleuca quinquenervia* Broad-leaved Paperbark
- Tristanopsis laurina* 'Luscious' Water Gum
- Ulmus parvifolia* 'Todd' Todd Chinese Elm
- Waterhousea floribunda* Weeping Lilly Pilly

TREES/ SCREEN SHRUBS

- Acer negundo* 'Sensation' Manitob Maple



Studio 1, 88 Fern Street
PO Box 111
Islington NSW 2296
Phone (02) 4965 3500
admin@moirla.com.au
www.moirla.com.au

ARCHITECT:
Barker Ryan Stewart

CLIENT:
Alda Properties Pty Ltd

NOTE: DRAWING PURPOSES FOR APPROVAL ONLY. NOT FOR CONSTRUCTION.

No: DATE: REVISION:
A 28/8/23 FOR APPROVAL
B 21/11/23 FOR APPROVAL
C 1/5/24 FOR APPROVAL
D 21/5/24 FOR APPROVAL
E 11/3/25 FOR APPROVAL
F 11/3/25 FOR APPROVAL

BY: PROJECT:
CN Proposed Subdivision
RD Darkinjung & Awabakal Country
CL 285 - 305 Pacific Highway, Lake Munmorah NSW
CL
MG
MG
Status: FOR APPROVAL

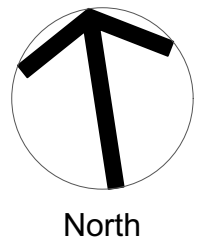

LANDSCAPE PLAN - PART I

SCALE: 1:250
ORIGINAL DRAWING AT A1.
Drawn By: RD
Checked By: YZ

Project No. 2353
Drawing No. LDD409
Rev F



LEGEND

- Stage boundary
- Lot boundary
- Concrete footpath - by others (P1)
- Driveway - by others (P2)
- Proposed lots
- Drainage reserve
- Road - by others
- Turf (T)
- Mulch Softfall
- Rubber Softfall
- Sandstone Log Wall and Seating
- Scour Protection to Engineers Detail
- Lapped and Capped Acoustic Wall - 1.8m high
- C2 Land Boundary

MASS PLANTING

- Mass Planting Type 1 - Refer Plant Schedule (MP1)
- Mass Planting Type 2 - Refer Plant Schedule (MP2)
- Mass Planting Type 3 - Refer Plant Schedule (MP3)
- Mass Planting Type 4 - Refer Plant Schedule (MP4)
- Mass Planting Type 5 - Refer Plant Schedule (MP5)

STREET TREES

- Corymbia maculata* Spotted Gum
- Corymbia eximia* 'Nana' Dwarf Yellow Bloodwood
- Lophostemon confertus* Brush Box
- Magnolia grandiflora* Bull Bay Magnolia
- Melaleuca quinquenervia* Broad-leaved Paperbark
- Tristaniopsis laurina* 'Luscious' Water Gum
- Ulmus parvifolia* 'Todd' Todd Chinese Elm
- Waterhousea floribunda* Weeping Lilly Pilly

TREES/ SCREEN SHRUBS

- Acer negundo* 'Sensation' Manitob Maple

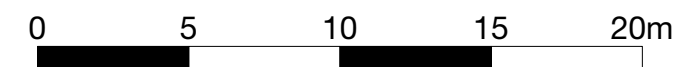

Studio 1, 88 Fern Street
PO Box 111
Islington NSW 2296
Phone (02) 4965 3500
admin@moirla.com.au
www.moirla.com.au

ARCHITECT:

ENGINEER:
Barker Ryan Stewart

CLIENT:

Alda Properties Pty Ltd

NOTE: DRAWING PURPOSES FOR APPROVAL ONLY. NOT FOR CONSTRUCTION.

No:	DATE:	REVISION:
A	28/8/23	FOR APPROVAL
B	21/11/23	FOR APPROVAL
C	1/5/24	FOR APPROVAL
D	21/5/24	FOR APPROVAL
E	11/3/25	FOR APPROVAL
F	11/3/25	FOR APPROVAL

BY:
CN
RD
CL
CL
MG
MG

PROJECT:

Proposed Subdivision
Darkinjung & Awabakal Country
285 - 305 Pacific Highway, Lake Munmorah NSW
Status: FOR APPROVAL

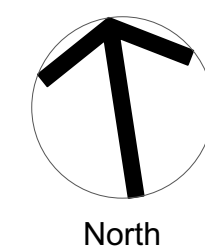

LANDSCAPE PLAN - PART J

SCALE: 1:250

ORIGINAL DRAWING AT A1.
Drawn By: RD
Checked By: YZ

Project No.

2353

Drawing No.

LDD410

Rev

F

REFER TO LDD 410 - LANDSCAPE PLAN - PART J



REFER TO LDD 416 - LANDSCAPE PLAN - PART P

LEGEND

- Stage boundary
- Lot boundary
- Concrete footpath - by others
- Driveway - by others
- Proposed lots
- Drainage reserve
- Road - by others
- Turf
- Mulch Softfall
- Rubber Softfall
- Sandstone Log Wall and Seating
- Scour Protection to Engineers Detail
- Lapped and Capped Acoustic Wall - 1.8m high
- C2 Land Boundary

MASS PLANTING

- Mass Planting Type 1 - Refer Plant Schedule
- Mass Planting Type 2 - Refer Plant Schedule
- Mass Planting Type 3 - Refer Plant Schedule
- Mass Planting Type 4 - Refer Plant Schedule
- Mass Planting Type 5 - Refer Plant Schedule

STREET TREES

- Corymbia maculata* Spotted Gum
- Corymbia eximia* 'Nana' Dwarf Yellow Bloodwood
- Lophostemon confertus* Brush Box
- Magnolia grandiflora* Bull Bay Magnolia
- Melaleuca quinquenervia* Broad-leaved Paperbark
- Tristanopsis laurina* 'Luscious' Water Gum
- Ulmus parvifolia* 'Todd' Todd Chinese Elm
- Waterhousea floribunda* Weeping Lilly Pilly

TREES/ SCREEN SHRUBS

- Acer negundo* 'Sensation' Manitob Maple

0 5 10 15 20m



Studio 1, 88 Fern Street
PO Box 111
Islington NSW 2296
Phone (02) 4965 3500
admin@moirla.com.au
www.moirla.com.au

ARCHITECT:

ENGINEER:

Barker Ryan Stewart

CLIENT:

Alda Properties Pty Ltd

NOTE: DRAWING PURPOSES FOR APPROVAL ONLY. NOT FOR CONSTRUCTION.

No: DATE: REVISION:
A 28/8/23 FOR APPROVAL
B 21/11/23 FOR APPROVAL
C 1/5/24 FOR APPROVAL
D 21/5/24 FOR APPROVAL
E 11/3/25 FOR APPROVAL
F 11/3/25 FOR APPROVAL

BY: CN RD CL CL MG MG

PROJECT:

Proposed Subdivision

Darkinjung & Awabakal Country

285 - 305 Pacific Highway, Lake Munmorah NSW

Status: FOR APPROVAL

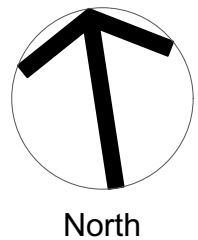

LANDSCAPE PLAN - PART K

SCALE: 1:250

ORIGINAL DRAWING AT A1.
Drawn By: RD
Checked By: YZ

Project No.

Drawing No.

LDD411

2353

Rev

F

REFER TO LDD 407 - LANDSCAPE PLAN - PART G

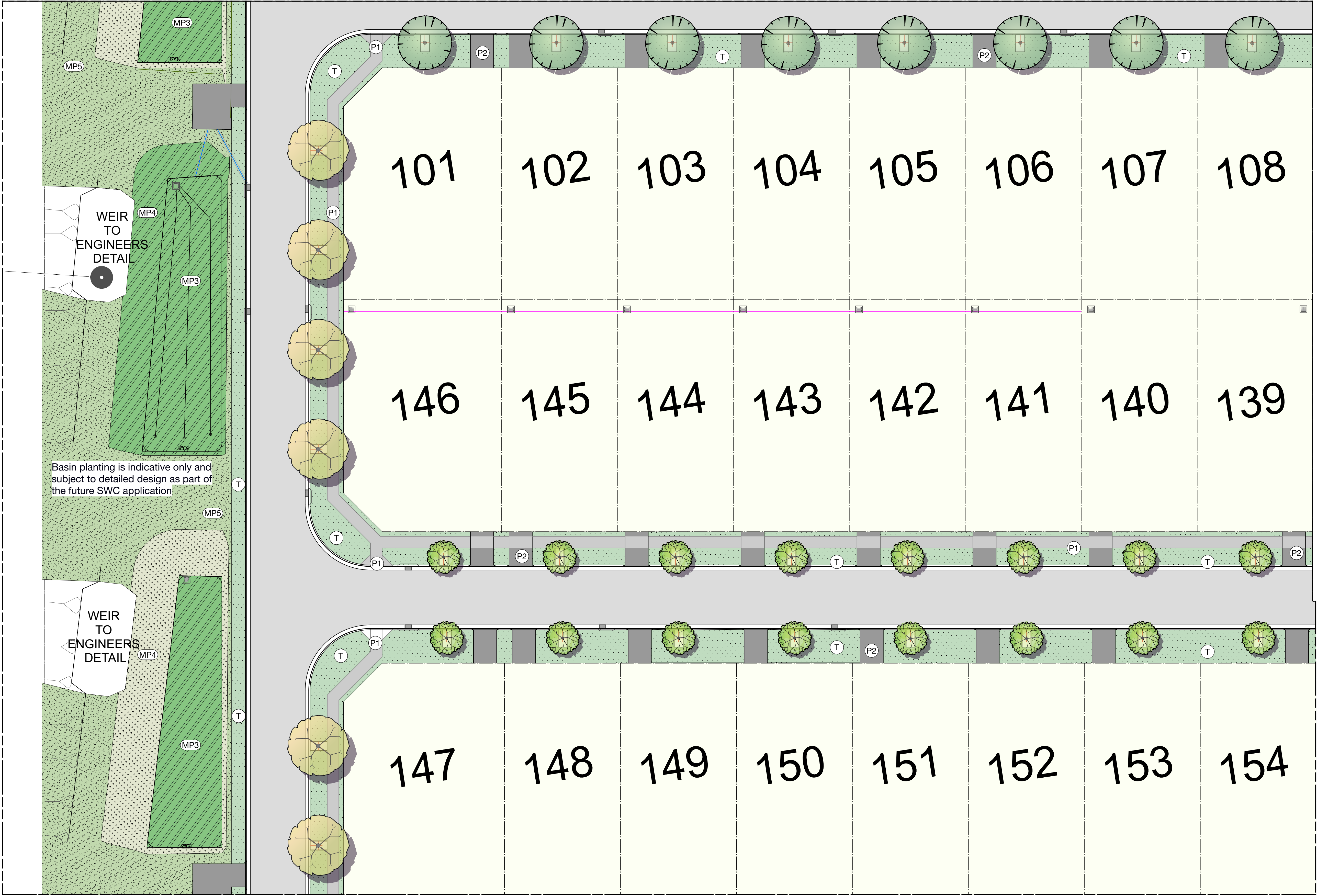

REFER TO LDD 417 - LANDSCAPE PLAN - PART Q

LEGEND

- Stage boundary
- Lot boundary
- Concrete footpath - by others
- Driveway - by others
- Proposed lots
- Drainage reserve
- Road - by others
- Turf
- Mulch Softfall
- Rubber Softfall
- Sandstone Log Wall and Seating
- Scour Protection to Engineers Detail
- Lapped and Capped Acoustic Wall - 1.8m high
- C2 Land Boundary

MASS PLANTING

- Mass Planting Type 1 - Refer Plant Schedule
- Mass Planting Type 2 - Refer Plant Schedule
- Mass Planting Type 3 - Refer Plant Schedule
- Mass Planting Type 4 - Refer Plant Schedule
- Mass Planting Type 5 - Refer Plant Schedule

STREET TREES

- Corymbia maculata* Spotted Gum
- Corymbia eximia* 'Nana' Dwarf Yellow Bloodwood
- Lophostemon confertus* Brush Box
- Magnolia grandiflora* Bull Bay Magnolia
- Melaleuca quinquenervia* Broad-leaved Paperbark
- Tristaniopsis laurina* 'Luscious' Water Gum
- Ulmus parvifolia* 'Todd' Todd Chinese Elm
- Waterhousea floribunda* Weeping Lilly Pilly

TREES/ SCREEN SHRUBS

- Acer negundo* 'Sensation' Manitoba Maple

REFER TO LDD 413 - LANDSCAPE PLAN - PART M

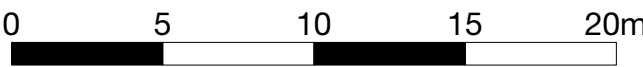

Studio 1, 88 Fern Street
PO Box 111
Islington NSW 2296
Phone (02) 4965 3500
admin@moirla.com.au
www.moirla.com.au

ARCHITECT:

ENGINEER:

Barker Ryan Stewart

CLIENT:

Alda Properties Pty Ltd

NOTE: DRAWING PURPOSES FOR APPROVAL ONLY. NOT FOR CONSTRUCTION.

No: DATE: REVISION:
A 28/8/23 FOR APPROVAL
B 21/11/23 FOR APPROVAL
C 1/5/24 FOR APPROVAL
D 21/5/24 FOR APPROVAL
E 11/3/25 FOR APPROVAL
F 11/3/25 FOR APPROVAL

BY: CN RD CL CL CL MG MG

PROJECT:

Proposed Subdivision

Darkinjung & Awabakal Country

285 - 305 Pacific Highway, Lake Munmorah NSW

Status: FOR APPROVAL

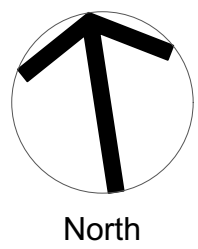

LANDSCAPE PLAN - PART L

SCALE: 1:250

ORIGINAL DRAWING AT A1.

Drawn By: RD

Checked By: YZ

Project No.

2353

Drawing No.

LDD412

Rev F

REFER TO LDD 408 - LANDSCAPE PLAN - PART H

REFER TO LDD 412 - LANDSCAPE PLAN - PART L

REFER TO LDD 417 - LANDSCAPE PLAN - PART Q

REFER TO LDD 418 - LANDSCAPE PLAN - PART R

REFER TO LDD 414 - LANDSCAPE PLAN - PART N

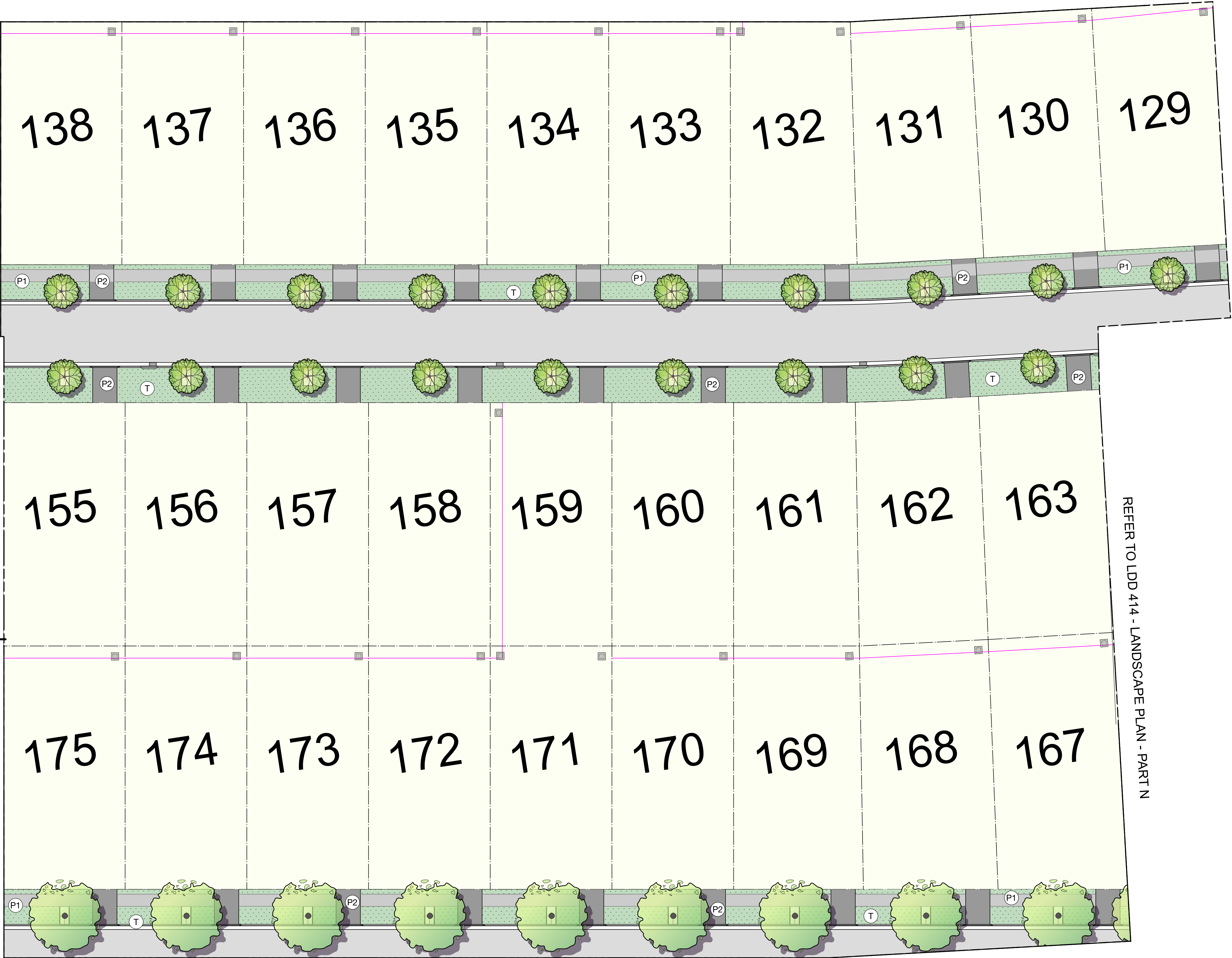

LEGEND

- Stage boundary
- Lot boundary
- Concrete footpath - by others (P1)
- Driveway - by others (P2)
- Proposed lots
- Drainage reserve
- Road - by others
- Turf (T)
- Mulch Softfall
- Rubber Softfall
- Sandstone Log Wall and Seating
- Scour Protection to Engineers Detail
- Lapped and Capped Acoustic Wall - 1.8m high
- C2 Land Boundary

MASS PLANTING

- Mass Planting Type 1 - Refer Plant Schedule (MP1)
- Mass Planting Type 2 - Refer Plant Schedule (MP2)
- Mass Planting Type 3 - Refer Plant Schedule (MP3)
- Mass Planting Type 4 - Refer Plant Schedule (MP4)
- Mass Planting Type 5 - Refer Plant Schedule (MP5)

STREET TREES

- Corymbia maculata* Spotted Gum
- Corymbia eximia* 'Nana' Dwarf Yellow Bloodwood
- Lophostemon confertus* Brush Box
- Magnolia grandiflora* Bull Bay Magnolia
- Melaleuca quinquenervia* Broad-leaved Paperbark
- Tristania laurina* 'Luscious' Water Gum
- Ulmus parvifolia* 'Todd' Todd Chinese Elm
- Waterhousea floribunda* Weeping Lilly Pilly

TREES/ SCREEN SHRUBS

- Acer negundo* 'Sensation' Manitob Maple

0 5 10 15 20m



Studio 1, 88 Fern Street
PO Box 111
Islington NSW 2296
Phone (02) 4965 3500
admin@moirla.com.au
www.moirla.com.au

ARCHITECT:

ENGINEER:

Barker Ryan Stewart

CLIENT:

Alda Properties Pty Ltd

NOTE: DRAWING PURPOSES FOR APPROVAL ONLY. NOT FOR CONSTRUCTION.

No: DATE: REVISION:
A 28/8/23 FOR APPROVAL
B 21/11/23 FOR APPROVAL
C 1/5/24 FOR APPROVAL
D 21/5/24 FOR APPROVAL
E 11/3/25 FOR APPROVAL
F 11/3/25 FOR APPROVAL

BY: CN RD CL CL MG MG

PROJECT:

Proposed Subdivision

Darkinjung & Awabakal Country

285 - 305 Pacific Highway, Lake Munmorah NSW

Status: FOR APPROVAL

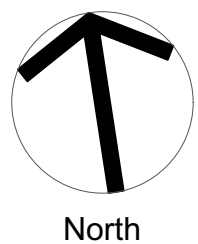

LANDSCAPE PLAN - PART M

SCALE: 1:250

ORIGINAL DRAWING AT A1.

Drawn By: RD

Checked By: YZ

Project No.

2353

Drawing No.

LDD413

Rev F



- LEGEND**
- Stage boundary
 - Lot boundary
 - Concrete footpath - by others
 - Driveway - by others
 - Proposed lots
 - Drainage reserve
 - Road - by others
 - Turf
 - Mulch Softfall
 - Rubber Softfall
 - Sandstone Log Wall and Seating
 - Scour Protection to Engineers Detail
 - Lapped and Capped Acoustic Wall - 1.8m high
 - C2 Land Boundary
- MASS PLANTING**
- MP1 Mass Planting Type 1 - Refer Plant Schedule
 - MP2 Mass Planting Type 2 - Refer Plant Schedule
 - MP3 Mass Planting Type 3 - Refer Plant Schedule
 - MP4 Mass Planting Type 4 - Refer Plant Schedule
 - MP5 Mass Planting Type 5 - Refer Plant Schedule
- STREET TREES**
- Corymbia maculata* Spotted Gum
 - Corymbia eximia* 'Nana' Dwarf Yellow Bloodwood
 - Lophostemon confertus* Brush Box
 - Magnolia grandiflora* Bull Bay Magnolia
 - Melaleuca quinquenervia* Broad-leaved Paperbark
 - Tristanopsis laurina* 'Luscious' Water Gum
 - Ulmus parvifolia* 'Todd' Todd Chinese Elm
 - Waterhousea floribunda* Weeping Lilly Pilly
- TREES/ SCREEN SHRUBS**
- Acer negundo* 'Sensation' Manito Maple

REFER TO LDD 419 - LANDSCAPE PLAN - PART S

REFER TO LDD 419 - LANDSCAPE PLAN - PART S

0 5 10 15 20m



Studio 1, 88 Fern Street
PO Box 111
Islington NSW 2296
Phone (02) 4965 3500
admin@moirla.com.au
www.moirla.com.au

ARCHITECT:

ENGINEER:
Barker Ryan Stewart

CLIENT:

Alda Properties Pty Ltd

NOTE: DRAWING PURPOSES FOR APPROVAL ONLY. NOT FOR CONSTRUCTION.

No:	DATE:	REVISION:
A	28/8/23	FOR APPROVAL
B	21/11/23	FOR APPROVAL
C	1/5/24	FOR APPROVAL
D	21/5/24	FOR APPROVAL
E	11/3/25	FOR APPROVAL
F	11/3/25	FOR APPROVAL

BY:
CN
RD
CL
CL
MG
MG

PROJECT:

Proposed Subdivision

Darkinjung & Awabakal Country

285 - 305 Pacific Highway, Lake Munmorah NSW

Status: FOR APPROVAL

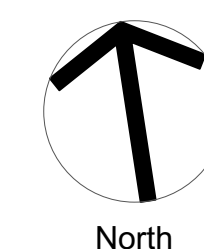

LANDSCAPE PLAN - PART N

SCALE: 1:250

ORIGINAL DRAWING AT A1.

Drawn By: RD

Checked By: YZ

Project No.

2353

Drawing No.

LDD414

Rev

F

REFER TO LDD 409 - LANDSCAPE PLAN - PART I

REFER TO LDD 414 - LANDSCAPE PLAN - PART N

REFER TO LDD 410 - LANDSCAPE PLAN - PART J

REFER TO LDD 420 - LANDSCAPE PLAN - PART T

LEGEND

- Stage boundary
- Lot boundary
- Concrete footpath - by others (P1)
- Driveway - by others (P2)
- Proposed lots
- Drainage reserve
- Road - by others
- Turf (T)
- Mulch Softfall
- Rubber Softfall
- Sandstone Log Wall and Seating
- Scour Protection to Engineers Detail
- Lapped and Capped Acoustic Wall - 1.8m high
- C2 Land Boundary

MASS PLANTING

- Mass Planting Type 1 - Refer Plant Schedule (MP1)
- Mass Planting Type 2 - Refer Plant Schedule (MP2)
- Mass Planting Type 3 - Refer Plant Schedule (MP3)
- Mass Planting Type 4 - Refer Plant Schedule (MP4)
- Mass Planting Type 5 - Refer Plant Schedule (MP5)

STREET TREES

- Corymbia maculata* Spotted Gum
- Corymbia eximia* 'Nana' Dwarf Yellow Bloodwood
- Lophostemon confertus* Brush Box
- Magnolia grandiflora* Bull Bay Magnolia
- Melaleuca quinquenervia* Broad-leaved Paperbark
- Tristaniopsis laurina* 'Luscious' Water Gum
- Ulmus parvifolia* 'Todd' Todd Chinese Elm
- Waterhousea floribunda* Weeping Lilly Pilly

TREES/ SCREEN SHRUBS

- Acer negundo* 'Sensation' Manitob Maple

0 5 10 15 20m



Studio 1, 88 Fern Street
PO Box 111
Islington NSW 2296
Phone (02) 4965 3500
admin@moirla.com.au
www.moirla.com.au

ARCHITECT:

ENGINEER:
Barker Ryan Stewart

CLIENT:

Alda Properties Pty Ltd

NOTE: DRAWING PURPOSES FOR APPROVAL ONLY. NOT FOR CONSTRUCTION.

No:	DATE:	REVISION:
A	28/8/23	FOR APPROVAL
B	21/11/23	FOR APPROVAL
C	1/5/24	FOR APPROVAL
D	21/5/24	FOR APPROVAL
E	11/3/25	FOR APPROVAL
F	11/3/25	FOR APPROVAL

BY:
CN
RD
CL
CL
MG
MG

PROJECT:

Proposed Subdivision
Darkinjung & Awabakal Country
285 - 305 Pacific Highway, Lake Munmorah NSW
Status: FOR APPROVAL

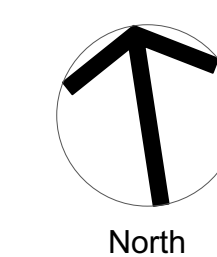

LANDSCAPE PLAN - PART O

SCALE: 1:250

ORIGINAL DRAWING AT A1.
Drawn By: RD
Checked By: YZ

Project No.

2353

Drawing No.

LDD415

Rev

F

REFER TO LDD 415 - LANDSCAPE PLAN - PART O

REFER TO LDD 411 - LANDSCAPE PLAN - PART K

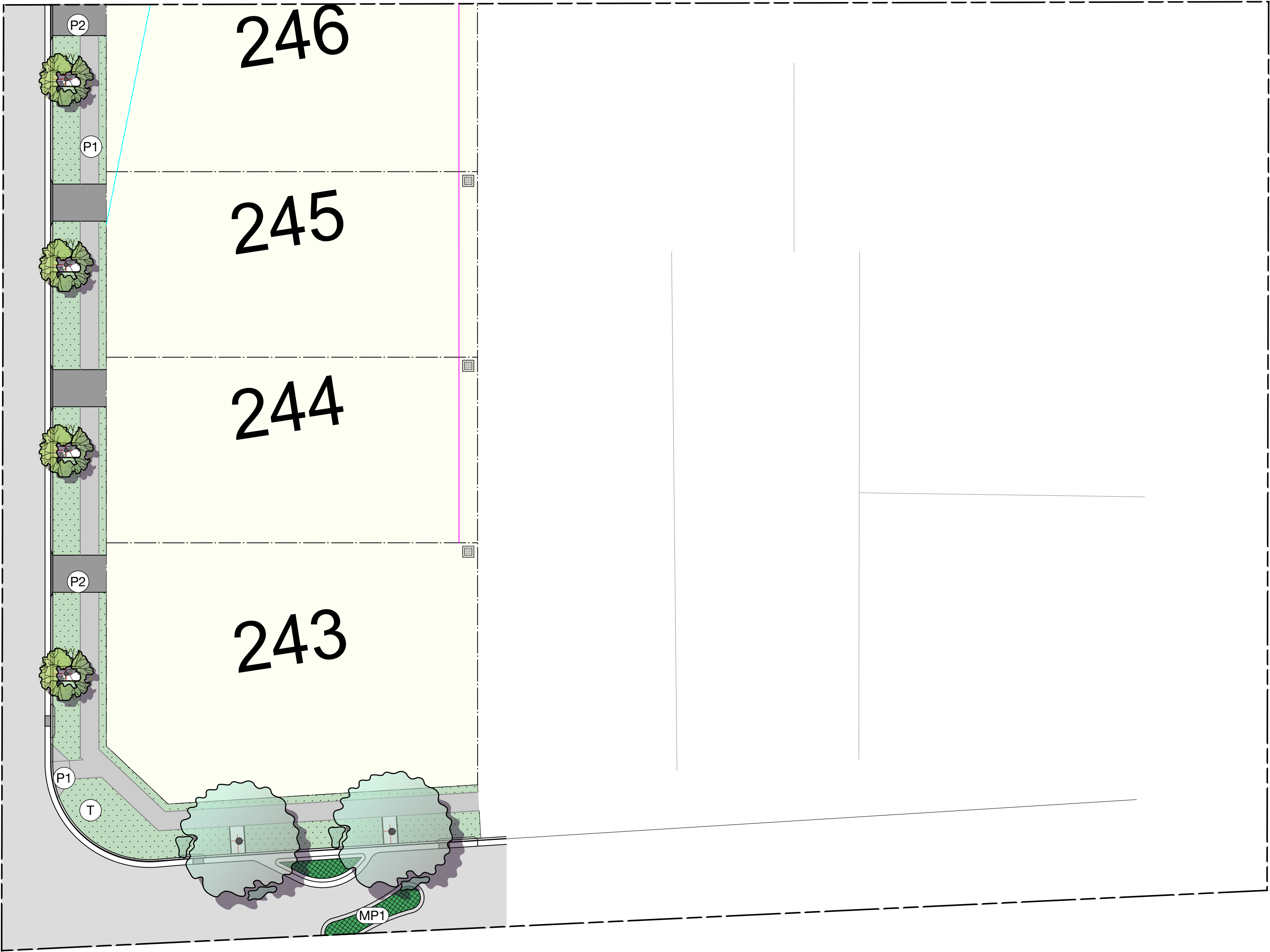

LEGEND

- Stage boundary
- Lot boundary
- Concrete footpath - by others (P1)
- Driveway - by others (P2)
- Proposed lots
- Drainage reserve
- Road - by others
- Turf (T)
- Mulch Softfall
- Rubber Softfall
- Sandstone Log Wall and Seating
- Scour Protection to Engineers Detail
- Lapped and Capped Acoustic Wall - 1.8m high
- C2 Land Boundary

MASS PLANTING

- Mass Planting Type 1 - Refer Plant Schedule (MP1)
- Mass Planting Type 2 - Refer Plant Schedule (MP2)
- Mass Planting Type 3 - Refer Plant Schedule (MP3)
- Mass Planting Type 4 - Refer Plant Schedule (MP4)
- Mass Planting Type 5 - Refer Plant Schedule (MP5)

STREET TREES

- Corymbia maculata* Spotted Gum
- Corymbia eximia* 'Nana' Dwarf Yellow Bloodwood
- Lophostemon confertus* Brush Box
- Magnolia grandiflora* Bull Bay Magnolia
- Melaleuca quinquenervia* Broad-leaved Paperbark
- Tristaniopsis laurina* 'Luscious' Water Gum
- Ulmus parvifolia* 'Todd' Todd Chinese Elm
- Waterhousea floribunda* Weeping Lilly Pilly

TREES/ SCREEN SHRUBS

- Acer negundo* 'Sensation' Manitob Maple

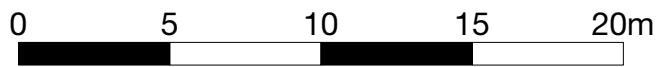

Studio 1, 88 Fern Street
PO Box 111
Islington NSW 2296
Phone (02) 4965 3500
admin@moirla.com.au
www.moirla.com.au

ARCHITECT:

ENGINEER:

Barker Ryan Stewart

CLIENT:

Alda Properties Pty Ltd

NOTE: DRAWING PURPOSES FOR APPROVAL ONLY. NOT FOR CONSTRUCTION.

No:	DATE:	REVISION:
A	28/8/23	FOR APPROVAL
B	21/11/23	FOR APPROVAL
C	1/5/24	FOR APPROVAL
D	21/5/24	FOR APPROVAL
E	11/3/25	FOR APPROVAL
F	11/3/25	FOR APPROVAL

BY:
CN
RD
CL
CL
MG
MG

PROJECT:

Proposed Subdivision

Darkinjung & Awabakal Country

285 - 305 Pacific Highway, Lake Munmorah NSW

Status: FOR APPROVAL

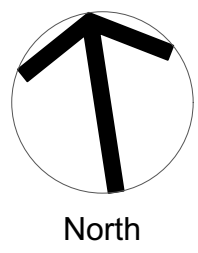

LANDSCAPE PLAN - PART P

SCALE: 1:250

ORIGINAL DRAWING AT A1.

Drawn By: RD

Checked By: YZ

Project No.

2353

Drawing No.

LDD416

Rev F

REFER TO LDD 412 - LANDSCAPE PLAN - PART L

REFER TO LDD 413 - LANDSCAPE PLAN - PART M

REFER TO LDD 418 - LANDSCAPE PLAN - PART R

LEGEND

- Stage boundary
- Lot boundary
- P1 Concrete footpath - by others
- P2 Driveway - by others
- Proposed lots
- Drainage reserve
- Road - by others
- T Turf
- Mulch Softfall
- Rubber Softfall
- Sandstone Log Wall and Seating
- Scour Protection to Engineers Detail
- Lapped and Capped Acoustic Wall - 1.8m high
- C2 Land Boundary

MASS PLANTING

- MP1 Mass Planting Type 1 - Refer Plant Schedule
- MP2 Mass Planting Type 2 - Refer Plant Schedule
- MP3 Mass Planting Type 3 - Refer Plant Schedule
- MP4 Mass Planting Type 4 - Refer Plant Schedule
- MP5 Mass Planting Type 5 - Refer Plant Schedule

STREET TREES

- Corymbia maculata Spotted Gum
- Corymbia eximia 'Nana' Dwarf Yellow Bloodwood
- Lophostemon confertus Brush Box
- Magnolia grandiflora Bull Bay Magnolia
- Melaleuca quinquenervia Broad-leaved Paperbark
- Tristaniopsis laurina 'Luscious' Water Gum
- Ulmus parvifolia 'Todd' Todd Chinese Elm
- Waterhousea floribunda Weeping Lilly Pilly

TREES/ SCREEN SHRUBS

- Acer negundo 'Sensation' Manitoba Maple

LANDSCAPE PLAN - PART Q

SCALE: 1:250

ORIGINAL DRAWING AT A1.
Drawn By: RD
Checked By: YZ

Project No.

Drawing No. 2353
Rev F
LDD417

Approved By: DM

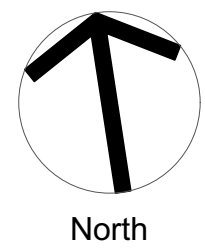

0 5 10 15 20m



Studio 1, 88 Fern Street
PO Box 111
Islington NSW 2296
Phone (02) 4965 3500
admin@moirla.com.au
www.moirla.com.au

ARCHITECT:

ENGINEER:

Barker Ryan Stewart

CLIENT:

Alda Properties Pty Ltd

NOTE: DRAWING PURPOSES FOR APPROVAL ONLY. NOT FOR CONSTRUCTION.

No:	DATE:	REVISION:
A	28/8/23	FOR APPROVAL
B	21/11/23	FOR APPROVAL
C	1/5/24	FOR APPROVAL
D	21/5/24	FOR APPROVAL
E	11/3/25	FOR APPROVAL
F	11/3/25	FOR APPROVAL

BY:
CN
RD
CL
CL
MG
MG

PROJECT:

Proposed Subdivision

Darkinjung & Awabakal Country

285 - 305 Pacific Highway, Lake Munmorah NSW

Status: FOR APPROVAL

REFER TO LDD 413 - LANDSCAPE PLAN - PART M

REFER TO LDD 417 - LANDSCAPE PLAN - PART Q

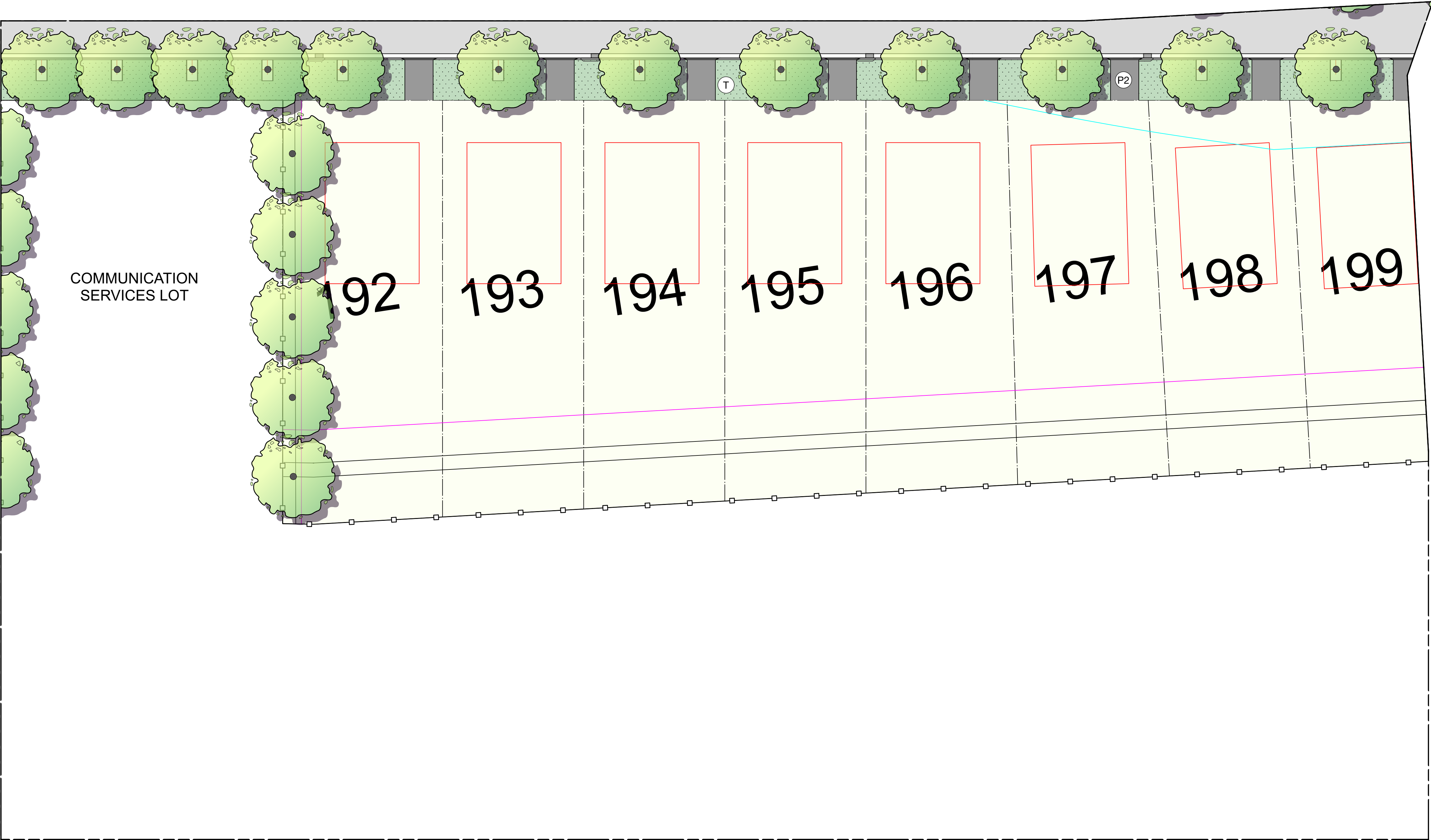

REFER TO LDD 419 - LANDSCAPE PLAN - PART S

LEGEND

- Stage boundary
- Lot boundary
- Concrete footpath - by others (P1)
- Driveway - by others (P2)
- Proposed lots
- Drainage reserve
- Road - by others
- Turf (T)
- Mulch Softfall
- Rubber Softfall
- Sandstone Log Wall and Seating
- Scour Protection to Engineers Detail
- Lapped and Capped Acoustic Wall - 1.8m high
- C2 Land Boundary

MASS PLANTING

- Mass Planting Type 1 - Refer Plant Schedule (MP1)
- Mass Planting Type 2 - Refer Plant Schedule (MP2)
- Mass Planting Type 3 - Refer Plant Schedule (MP3)
- Mass Planting Type 4 - Refer Plant Schedule (MP4)
- Mass Planting Type 5 - Refer Plant Schedule (MP5)

STREET TREES

- Corymbia maculata* Spotted Gum
- Corymbia eximia* 'Nana' Dwarf Yellow Bloodwood
- Lophostemon confertus* Brush Box
- Magnolia grandiflora* Bull Bay Magnolia
- Melaleuca quinquenervia* Broad-leaved Paperbark
- Tristaniopsis laurina* 'Luscious' Water Gum
- Ulmus parvifolia* 'Todd' Todd Chinese Elm
- Waterhousea floribunda* Weeping Lilly Pilly

TREES/ SCREEN SHRUBS

- Acer negundo* 'Sensation' Manitob Maple

0 5 10 15 20m



Studio 1, 88 Fern Street
PO Box 111
Islington NSW 2296
Phone (02) 4965 3500
admin@moirla.com.au
www.moirla.com.au

ARCHITECT:
Alda Properties Pty Ltd

ENGINEER:
Barker Ryan Stewart

CLIENT:
Alda Properties Pty Ltd

NOTE: DRAWING PURPOSES FOR APPROVAL ONLY. NOT FOR CONSTRUCTION.

No: DATE: REVISION:
A 28/8/23 FOR APPROVAL
B 21/11/23 FOR APPROVAL
C 1/5/24 FOR APPROVAL
D 21/5/24 FOR APPROVAL
E 11/3/25 FOR APPROVAL
F 11/3/25 FOR APPROVAL

BY: CN RD CL CL MG MG
PROJECT:
Proposed Subdivision
Darkinjung & Awabakal Country
285 - 305 Pacific Highway, Lake Munmorah NSW
Status: FOR APPROVAL

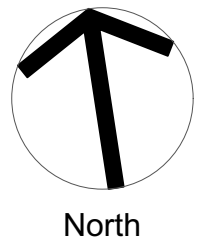

LANDSCAPE PLAN - PART R

SCALE: 1:250 Project No. 2353
ORIGINAL DRAWING AT A1. Drawing No. Rev
Checked By: YZ Approved By: DM LDD418 F

REFER TO LDD 418 - LANDSCAPE PLAN - PART R



REFER TO LDD 420 - LANDSCAPE PLAN - PART T

LEGEND

- Stage boundary
- Lot boundary
- Concrete footpath - by others (P1)
- Driveway - by others (P2)
- Proposed lots
- Drainage reserve
- Road - by others
- Turf (T)
- Mulch Softfall
- Rubber Softfall
- Sandstone Log Wall and Seating
- Scour Protection to Engineers Detail
- Lapped and Capped Acoustic Wall - 1.8m high
- C2 Land Boundary

MASS PLANTING

- Mass Planting Type 1 - Refer Plant Schedule (MP1)
- Mass Planting Type 2 - Refer Plant Schedule (MP2)
- Mass Planting Type 3 - Refer Plant Schedule (MP3)
- Mass Planting Type 4 - Refer Plant Schedule (MP4)
- Mass Planting Type 5 - Refer Plant Schedule (MP5)

STREET TREES

- Corymbia maculata* Spotted Gum
- Corymbia eximia* 'Nana' Dwarf Yellow Bloodwood
- Lophostemon confertus* Brush Box
- Magnolia grandiflora* Bull Bay Magnolia
- Melaleuca quinquenervia* Broad-leaved Paperbark
- Tristaniopsis laurina* 'Luscious' Water Gum
- Ulmus parvifolia* 'Todd' Todd Chinese Elm
- Waterhousea floribunda* Weeping Lilly Pilly

TREES/ SCREEN SHRUBS

- Acer negundo* 'Sensation' Manitob Maple



Studio 1, 88 Fern Street
PO Box 111
Islington NSW 2296
Phone (02) 4965 3500
admin@moirla.com.au
www.moirla.com.au

ARCHITECT:

ENGINEER:
Barker Ryan Stewart

CLIENT:

Alda Properties Pty Ltd

NOTE: DRAWING PURPOSES FOR APPROVAL ONLY. NOT FOR CONSTRUCTION.

No:	DATE:	REVISION:
A	28/8/23	FOR APPROVAL
B	21/11/23	FOR APPROVAL
C	1/5/24	FOR APPROVAL
D	21/5/24	FOR APPROVAL
E	11/3/25	FOR APPROVAL
F	11/3/25	FOR APPROVAL

BY:
CN
RD
CL
CL
MG
MG

PROJECT:

Proposed Subdivision
Darkinjung & Awabakal Country
285 - 305 Pacific Highway, Lake Munmorah NSW
Status: FOR APPROVAL

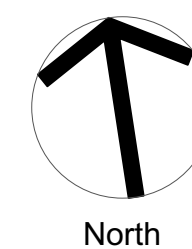

LANDSCAPE PLAN - PART S

SCALE: 1:250

ORIGINAL DRAWING AT A1.
Drawn By: RD
Checked By: YZ

Project No.

Drawing No. 2353
Rev F
Approved By: DM



LEGEND

- Stage boundary
- Lot boundary
- Concrete footpath - by others (P1)
- Driveway - by others (P2)
- Proposed lots
- Drainage reserve
- Road - by others
- Turf (T)
- Mulch Softfall
- Rubber Softfall
- Sandstone Log Wall and Seating
- Scour Protection to Engineers Detail
- Lapped and Capped Acoustic Wall - 1.8m high
- C2 Land Boundary

MASS PLANTING

- Mass Planting Type 1 - Refer Plant Schedule (MP1)
- Mass Planting Type 2 - Refer Plant Schedule (MP2)
- Mass Planting Type 3 - Refer Plant Schedule (MP3)
- Mass Planting Type 4 - Refer Plant Schedule (MP4)
- Mass Planting Type 5 - Refer Plant Schedule (MP5)

STREET TREES

- Corymbia maculata* Spotted Gum
- Corymbia eximia* 'Nana' Dwarf Yellow Bloodwood
- Lophostemon confertus* Brush Box
- Magnolia grandiflora* Bull Bay Magnolia
- Melaleuca quinquenervia* Broad-leaved Paperbark
- Tristaniopsis laurina* 'Luscious' Water Gum
- Ulmus parvifolia* 'Todd' Todd Chinese Elm
- Waterhousea floribunda* Weeping Lilly Pilly

TREES/ SCREEN SHRUBS

- Acer negundo* 'Sensation' Manitob Maple

0 5 10 15 20m



Studio 1, 88 Fern Street
PO Box 111
Islington NSW 2296
Phone (02) 4965 3500
admin@moirla.com.au
www.moirla.com.au

ARCHITECT:
Alda Properties Pty Ltd
ENGINEER:
Barker Ryan Stewart

CLIENT:
Alda Properties Pty Ltd

NOTE: DRAWING PURPOSES FOR APPROVAL ONLY. NOT FOR CONSTRUCTION.

No: DATE: REVISION:
A 28/8/23 FOR APPROVAL
B 21/11/23 FOR APPROVAL
C 1/5/24 FOR APPROVAL
D 21/5/24 FOR APPROVAL
E 11/3/25 FOR APPROVAL
F 11/3/25 FOR APPROVAL

BY: PROJECT:
CN Proposed Subdivision
RD Darkinjung & Awabakal Country
CL 285 - 305 Pacific Highway, Lake Munmorah NSW
MG Status: FOR APPROVAL

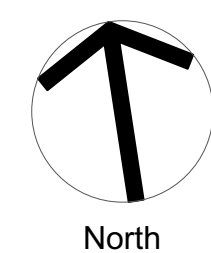

LANDSCAPE PLAN - PART T

SCALE: 1:250
ORIGINAL DRAWING AT A1.
Drawn By: RD
Checked By: YZ

Project No. 2353
Drawing No. LDD420
Rev F



Corymbia maculata



Corymbia eximia 'Nana'



Lophostemon confertus



Melaleuca quinquenervia



Tristaniopsis laurina 'Luscious'



Ulmus parvifolia 'Todd'

Planting Schedule

Code	Botanical Name	Common Name	Pot Size	Mature Height	Mature Spread	Notes
Street Trees						
COR mac	Corymbia maculata	Spotted Gum	75 litre	15 - 20m	6 - 10m	N / LF
COR nan	Corymbia eximia 'Nana'	Dwarf Yellow Bloodwood	25 litre	6 - 8m	4 - 6m	N
LOP con	Lophostemon confertus	Brush Box	75 litre	20 - 25m	6 - 10m	N / LF / K
MAG gra	Magnolia grandiflora	Bull Bay Magnolia	75 litre	15 - 20m	15 - 20m	E
MEL qui	Melaleuca quinquenervia	Broad-leaved Paperbark	75 litre	10 - 15m	4 - 6m	N / K
TRI lus	Tristaniopsis laurina 'Luscious'	Water Gum	75 litre	5 - 10m	4 - 6m	N
ULM tod	Ulmus parvifolia 'Todd'	Todd Chinese Elm	75 litre	8 - 10m	8 - 11m	N
WAT flo	Waterhousea floribunda	Weeping Lilly Pilly	75 litre	10 - 15m	6 - 8m	N

Trees

Mass Planting

MP1						Planting Rate
CAR app	Carex appressa	Tall Sedge	Tubestock	0.8 - 1.0m	0.6 - 0.9m	3 Plants/sq m
CAR gla	Carpobrotus glaucescens	Pigface	Tubestock	0.0 - 0.3m	1.2 - 2.0m	3 Plants/sq m
ENT str	Entolasia stricta	Wiry Panic	Tubestock	0.75 - 0.90m	0.3 - 0.6m	3 Plants/sq m
MYO yar	Myoporum parvifolium 'Yareena'	Myoporum Yareena	Tubestock	0.1m	0.7 - 1.0m	3 Plants/sq m
POA esk	Poa labillardieri 'Eskdale'	Tussock Grass	Tubestock	0.4 - 0.6m	0.3 - 0.5m	3 Plants/sq m
MP2						
BRA mul	Brachyscome multifida	Cut Leaf Daisy		0.3 - 0.45m	0.9 - 1.2m	4 Plants/sq m
CHR api	Chrysocephalum apiculatum	Yellow Buttons	Tubestock	0.0 - 0.3m	0.3 - 0.6m	4 Plants/sq m
DIA cab	Dianella caerulea 'Breeze'	Dianella Breeze	Tubestock	0.45 - 0.60m	0.6 - 0.9m	4 Plants/sq m
DIC cri	Dichelachne Crinita	Longhair Plume Grass	Tubestock	1.5m	0.6m	4 Plants/sq m
HAR mee	Hardenbergia violacea 'Meema'	False Sarsaparilla	Tubestock	0.45 - 0.6m	1.2 - 2.0m	4 Plants/sq m
LOM tan	Lomandra longifolia 'Tanika'	Spiny-headed mat rush	Tubestock	0.45 - 0.6m	0.6 - 0.9m	4 Plants/sq m
MYO par	Myoporum parvifolium	Boobialla	Tubestock	0.45 - 0.6m	0.9 - 1.2m	4 Plants/sq m
PEN rub	Pennisetum 'Rubrum'	Purple Fountain Grass	Tubestock	0.6 - 0.75m	0.3 - 0.6m	4 Plants/sq m
POA lab	Poa labillardieri	Tussock Grass	Tubestock	0.4 - 0.6m	0.3 - 0.5m	4 Plants/sq m
SCA alb	Scaevola albida	Coast fanflower	Tubestock	0.30 - 0.45m	1.2 - 2.0m	4 Plants/sq m
THE tri	Themeda triandra	Kangaroo Grass	Tubestock	0.4 - 0.7m	0.3 - 0.5m	4 Plants/sq m
MP3						
CAR app	Carex appressa	Tall Sedge	Tubestock	0.8 - 1.0m	0.6 - 0.9m	3 Plants/sq m
GAH cla	Gahnia clarkei	Tall Saw-Sedge	Tubestock	1.5 - 2.0m	1.2 - 1.5m	3 Plants/sq m
JUN usi	Juncus usitatus	Common Rush	Tubestock	0.9 - 1.5m	0.6 - 0.9m	3 Plants/sq m
LOM kat	Lomandra longifolia 'Katrinus'	Mat Rush	Tubestock	0.75 - 0.9m	0.6 - 0.9m	3 Plants/sq m
MP4						
CAR app	Carex appressa	Tall Sedge	Tubestock	0.8 - 1.0m	0.6 - 0.9m	3 Plants/sq m
DIA cab	Dianella caerulea 'Breeze'	Dianella Breeze	Tubestock	0.45 - 0.60m	0.6 - 0.9m	3 Plants/sq m
GAH cla	Gahnia clarkei	Tall Saw-Sedge	Tubestock	1.5 - 2.0m	1.2 - 1.5m	3 Plants/sq m
LOB pur	Lobelia purpurascens	Whiteroot	Tubestock	0.5 - 0.8m	0.3 - 0.6m	3 Plants/sq m
LOM lon	Lomandra longifolia	Spiny-headed Mat-Rush	Tubestock	0.6 - 0.9m	0.4 - 0.6m	3 Plants/sq m
MP5						
CAR app	Carex appressa	Tall Sedge	Tubestock	0.8 - 1.0m	0.6 - 0.9m	3 Plants/sq m
GRE bro	Grevillea 'Bronze Rambler'	Bronze Rambler Grevillea	Tubestock	0.0 - 0.3m	3 - 4m	3 Plants/sq m
HIB sca	Hibbertia scandens	Golden Guinea Flower	Tubestock	0.0 - 0.3m	3.5 - 6m	3 Plants/sq m
IMP cin	Imperata cylindrica	Blady Grass	Tubestock	0.4 - 0.7m	0.6 - 0.9m	3 Plants/sq m
PRA pur	Pratia purpurascens	White Root	Tubestock	0.0 - 0.3m	0.0 - 0.3m	3 Plants/sq m

MASS PLANTING SPECIES
INCREASED AND RATE DECREASED

MASS PLANTING



Carex appressa



Carpobrotus glaucescens



Entolasia stricta



Lomandra fluviatilis 'Shara'



Myoporum parvifolium



Poa labillardieri 'Eskdale'



Studio 1, 88 Fern Street
PO Box 111
Islington NSW 2296
Phone (02) 4965 3500
admin@moirla.com.au
www.moirla.com.au

ARCHITECT:

ENGINEER:

Barker Ryan Stewart

CLIENT:

Alda Properties Pty Ltd

NOTE: DRAWING PURPOSES FOR APPROVAL ONLY. NOT FOR CONSTRUCTION.

No:

DATE:
A 28/8/23
B 21/11/23
C 1/5/24
D 21/5/24
E 11/3/25
F 11/3/25

REVISION:

FOR APPROVAL
FOR APPROVAL
FOR APPROVAL
FOR APPROVAL
FOR APPROVAL
FOR APPROVAL

BY:

CN
RD
CL
CL
MG
MG

PROJECT:

Proposed Subdivision

Darkinjung & Awabakal Country

285 - 305 Pacific Highway, Lake Munmorah NSW

Status:

FOR APPROVAL

THEMING PLAN

SCALE:

N/A

Project No.

2353

ORIGINAL DRAWING AT A1.

Drawn By: RD

Drawing No.

LDD701

North

Checked By: YZ

Approved By: DM

Rev

F

SWING



Erbium Swing -
Lappset Erbium Swing with combination swing.

PICNIC SETTING



Street Furniture Australia Linea picnic setting

SHELTER



Landmark Designer curver roof shelter

COMBINATION PLAY STRUCTURE

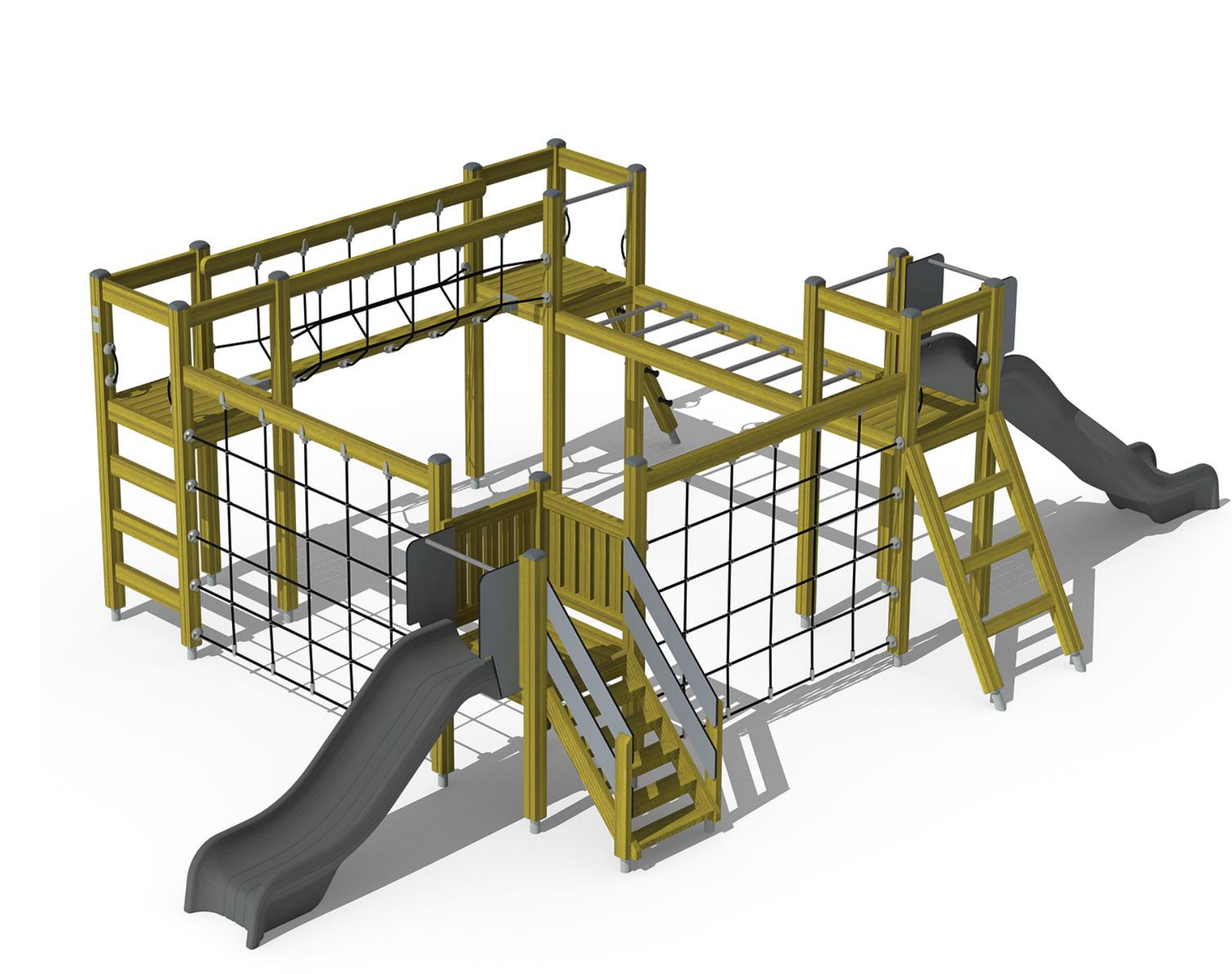

Lappset motoric track

ROCKER



Lappset whale rocker

ROCKER



Lappset grasshopper